



FRESNO COUNTY ZOO AUTHORITY

MEETING AGENDA

9:00 AM, Wednesday, October 26, 2022

Fresno County Employees' Retirement Association

7772 N. Palm Ave. Fresno, CA 93711

(559) 457-0681

1. Call to Order
2. Roll Call
3. Approve Agenda
4. Public Comments
This portion of the meeting is reserved for persons desiring to address the board on matters within the Board's jurisdiction that are not on the agenda. Attention is called to the fact that the Board is prohibited from taking any action on matters that are not on the agenda. Members of the public are limited to three minutes to speak during Public Comments as well as for each item on the agenda. Before beginning comments, please state for the record your name and affiliation, if any
5. Approve Consent Agenda Items
These matters are routine in nature and are usually approved by a single vote. Prior to action by the Board, the public will be given the opportunity to remove any item from the Consent Calendar. Items removed from the Consent Calendar may be heard immediately following approval of the Consent Calendar
 - a. Review and approve minutes of September 28, 2022
 - b. Review and approve payment of County of Fresno invoice for Professional and Specialized Services in the amount of \$18,112.32 for services through September 2022
 - c. Receive Treasurer's Reports for the month of September 2022 and Quarter ending September 2022
6. Receive Fresno Chaffee Zoo Director's report
7. Receive Fresno Chaffee Zoo Master Plan

8. Receive Fresno Chaffee Zoo Corporation's August 2022 Year-to-Date Financial Report and September 2022 Early Insights
9. Receive and approve request from Fresno Chaffee Zoo Corporation to release remaining Measure Z budgeted funds from the Mixed Species Demo in the total amount of \$1,727.50
10. Receive and approve request from Fresno Chaffee Zoo Corporation to release remaining Measure Z budgeted funds from the African River Design in the amount of \$2,830,342.30
11. Approve and authorize release of retention withheld on design work provided by Studio Hanson Roberts related to African River Exhibit (\$11,956.50)
12. Review next meeting date and revise if necessary:
 - Wednesday, November 30, 2022
 - Wednesday, December 28, 2022
13. Receive staff reports
14. Chair's comments
15. Board Member comments
16. Adjourn

All supporting documentation is available for public review in the office of the Fresno County Zoo Authority, 2281 Tulare Street, Room 304, Fresno, 93721, during regular business hours.

For further information, please contact Ronald Alexander, Zoo Authority Coordinator, at 600-1710, email zooauthority@co.fresno.ca.us, or visit www.zooauthority.org. Requests for disability-related modification or accommodation needed in order to participate in the meeting must be made to the Zoo Authority Coordinator no later than 9:00 a.m. on the day prior to the meeting.



AGENDA ITEM 5a

FRESNO COUNTY ZOO AUTHORITY

ACTION SUMMARY MINUTES

9:00 AM, Wednesday, September 28, 2022

Fresno County Employees' Retirement Association

7772 N. Palm Ave. Fresno, CA 93711

(559) 457-0681

1. Call to Order
CHAIRMAN ROMAN CALLED THE MEETING TO ORDER AT 9:04AM.
2. Roll Call
A QUORUM WAS PRESENT WITH MEMBERS ROMAN, TOSTE, GARABEDIAN, WATERHOUSE AND ARIAS IN ATTENDANCE.
3. Approve Agenda
MEMBER ARIAS MOVED TO ADOPT THE AGENDA. SECONDED BY MEMBER WATERHOUSE. THE MOTION PASSED UNANIMOUSLY.
4. Public Comments
This portion of the meeting is reserved for persons desiring to address the board on matters within the Board's jurisdiction that are not on the agenda. Attention is called to the fact that the Board is prohibited from taking any action on matters that are not on the agenda. Members of the public are limited to three minutes to speak during Public Comments as well as for each item on the agenda. Before beginning comments, please state for the record your name and affiliation, if any
HELD. NONE RECEIVED
5. Approve Consent Agenda Items
These matters are routine in nature and are usually approved by a single vote. Prior to action by the Board, the public will be given the opportunity to remove any item from the Consent Calendar. Items removed from the Consent Calendar may be heard immediately following approval of the Consent Calendar
 - a. Review and approve minutes of July 27, 2022
 - b. Review and approve payment of County of Fresno invoice for Professional and Specialized Services in the amount of \$10,078.55 for services through August 2022
 - c. Receive Treasurer's Reports for July and August 2022

MEMBER ARIAS MOVED TO APPROVE THE CONSENT ITEMS. SECONDED BY MEMBER WATERHOUSE. THE MOTION PASSED UNANIMOUSLY.

6. Present certificate to Kent L. Stratford for 17 years of service as a member of the Zoo Authority Board
STRATFORD WAS NOT IN ATTENDANCE; HOWEVER, CHAIRMAN ROMAN PRESENTED THE CERTIFICATE AND WILL GET IT MAILED TO STRATFORD.
7. Receive Fresno Chaffee Zoo Director's report
RECEIVED. CEO JON DOHLIN PROVIDED A CONSTRUCTION UPDATE FOR KINGDOMS OF ASIA.
8. Receive Business Plan Presentation from Fresno Chaffee Zoo consultant
RECEIVED. ZOO CONSULTANT, ZACH WINFIELD, PRESENTED THE CHAFFEE ZOO BUSINESS PLAN THAT CONSISTED OF A REVIEW OF PRELIMINARY OBSERVATIONS, KEY BUSINESS PLAN DRIVERS, AND A MODELING APPROACH AND OUTCOMES.
9. Receive Fresno Chaffee Zoo Corporation's July 2022 Year-to-Date Financial Report and August 2022 Early Insights
RECEIVED. CFO NORA CROW REPORTED ON REVENUES AND EXPENSES COMPARED TO BUDGET, OPERATING DEFICIT AND NET SURPLUS. REPORTED ON FREE TICKETS THROUGH PARTNERSHIP WITH ONEFRESNO AND THE HOUSING AUTHORITY. REPORTED ON ATTENDANCE, PER CAPITA SPENDING AND THE JULY AND AUGUST BALANCE SHEETS.
10. Approve Fresno Chaffee Zoo Corporation's request of Measure Z Capital funds totaling \$1,775,810.79 for the construction of the Conservation Building
MEMBER WATERHOUSE MOVED TO APPROVE MEASURE Z CAPITAL FUNDS TOTALING \$1,775,810.79 WITH THE INCLUSION OF A 15 PERCENT CONTINGENCY AS PRESENTED. THE MOTION DID NOT RECEIVE A SECOND AND FAILED. MEMBER GARABEDIAN MOVED TO APPROVE MEASURE Z CAPITAL FUNDS TOTALING \$1,775,810.79 INCLUDING A 10 PERCENT CONTINGENCY. SECONDED BY MEMBER WATERHOUSE. THE MOTION PASSED UNANIMOUSLY.
11. Review next meeting date and revise if necessary:

Wednesday, October 26, 2022
Wednesday, November 30, 2022
Wednesday, December 28, 2022

REVIEWED WITH NO REVISIONS TO THE SCHEDULE.
12. Receive staff reports
NO ADDITIONAL STAFF REPORTS RECEIVED.
13. Chair's comments
NOTED THAT SHE WILL SEE EVERYONE FRIDAY AT SAFARI NIGHT.
14. Board Member comments
MEMBER GARABEDIAN INQUIRED ABOUT FILLING THE VACANCY ON THE BOARD. NO UPDATES AT THIS TIME. CHAIRMAN ROMAN ASKED THE COORDINATOR TO SEND A NOTE TO THE DISTRICT 3 STAFF AS A REMINDER THAT THE POSITION IS STILL VACANT.
15. Adjourn

**THERE BEING NO FURTHER BUSINESS BEFORE THE BOARD, CHAIRMAN ROMAN
ADJOURNED THE MEETING AT 10:34AM.**

All supporting documentation is available for public review in the office of the Fresno County Zoo Authority, 2281 Tulare Street, Room 304, Fresno, 93721, during regular business hours.

For further information, please contact Ronald Alexander, Zoo Authority Coordinator, at 600-1710, email zooauthority@co.fresno.ca.us, or visit www.zooauthority.org. Requests for disability-related modification or accommodation needed in order to participate in the meeting must be made to the Zoo Authority Coordinator no later than 9:00 a.m. on the day prior to the meeting.



Invoice for Professional Services in Support of the Zoo Authority
Billing Hours and Expenses through September 2022

Invoice Number
10-ZOO-102622

October 26, 2022

TO: Zoo Authority Board
c/o County of Fresno
2281 Tulare St. Room 304
Fresno, CA 93721

| Department / Title | Hours | Rates | Cost |
|------------------------------------|---------------|----------|--------------------|
| ACTTC FR&A | | | |
| Accounting & Finance Div Chief | 0.25 | \$92.49 | \$23.12 |
| Accounting & Finance Manager | 0.00 | \$91.80 | \$0.00 |
| Accountant II | 5.00 | \$80.92 | \$404.60 |
| Accountant I | 18.46 | \$62.78 | \$1,158.92 |
| Account Clerk I | 0.00 | \$56.16 | \$0.00 |
| Account Clerk II | 34.00 | \$59.94 | \$2,037.96 |
| County Counsel | | | |
| Deputy County Counsel | | \$159.00 | \$0.00 |
| CAO | | | |
| Board Coordinator | 111.00 | \$130.52 | \$14,487.72 |
| Professional Services Total | 168.71 | | \$18,112.32 |
| Office Expense Total | | | |
| Invoice Total | | | \$18,112.32 |

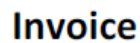

| | | |
|--------------|----------------|------------|
| | | |
| Invoice Date | Invoice Number | Due Date |
| 9/27/2022 | 2506 | 10/27/2022 |

MAKE YOUR REMITTANCE PAYABLE TO:

FRESNO COUNTY TREASURER

AND SEND IT TO THE FOLLOWING ADDRESS:

Oscar J. Garcia, CPA
AUDITOR-CONTROLLER/TREASURER TAX
COLLECTOR - ADMINISTRATION DIVISION

PO BOX 1247
FRESNO, CA 93715-1247

BILL TO:

Zoo Authority
Email to:
ronalexander@fresnocountyca.gov

PLEASE INCLUDE THE INVOICE NUMBER ON YOUR CHECK OR MONEY ORDER

[illegible]

INVOICE

DATE: October 1, 2022
INVOICE # 1013
FOR: *Zoo Authority
Administration*

| DESCRIPTION | AMOUNT |
|---|--------------|
| Zoo Authority Board Coordinator Services July, August, September 2022 | \$ 14,487.72 |
| | |
| | |
| | |
| | |
| | |
| | |
| | |
| | |
| | |
| | |
| TOTAL | \$ 14,487.72 |

AGENDA ITEM 5c



Fresno County Zoo Authority Treasurer's Report Unaudited Cash Basis For the Quarter Ended September 30, 2022

| Summary of Measure Z Proceeds | | | |
|--|---|-----------|----------------------|
| Tax Proceeds Received: | | | |
| - | Measure Z - Sales Tax Proceeds | \$ | 5,601,546.20 |
| | Total Proceeds Received: | \$ | 5,601,546.20 |
| Tax Proceeds Allocated: | | | |
| - | Allocation to Zoo Authority Fund (2%) | | 112,030.92 |
| - | Allocation to Trust Fund for Operations and Capital Projects (98%) | | 5,489,515.28 |
| | Total Proceed Allocations | \$ | 5,601,546.20 |
| Cash Balance by Fund | | | |
| Zoo Authority Fund >> Administrative Fund 2% | | | |
| | Beginning Cash Balance | \$ | 2,668,689.94 |
| Receipts: | - Measure Z Sales Tax Proceeds | | 112,030.92 |
| | - Interest Received | | 8,920.18 |
| Disbursements: | - PeopleSoft Financial Charges | | (123.24) |
| | - ZA Claim for Professional Services | | (10,078.55) |
| | Net Increase/(Decrease) to Cash | | 110,749.31 |
| | Ending Cash Balance - Zoo Authority Administrative Fund | \$ | 2,779,439.25 |
| Trust Fund for FCZC Operations and Capital Projects 98% | | | |
| | Beginning Cash Balance | \$ | 33,129,452.22 |
| >>> Operations Fund | | | |
| | Beginning Cash Balance | | 7,017,447.56 |
| Receipts: | - Measure Z Sales Tax Proceeds | | 1,829,838.43 |
| | - Interest Received | | 26,316.68 |
| | - FCZC Operations Claim #2022-06 | | (607,036.60) |
| | - FCZC Operations Claim #2022-07 | | (841,263.90) |
| | - Wire Fees | | (40.00) |
| | Net Increase/(Decrease) to Cash | | 407,814.61 |
| | Ending Cash Balance - Available for Operations | \$ | 7,425,262.17 |
| >>> Capital Facilities Project Fund | | | |
| | Beginning Cash Balance | \$ | 26,112,004.66 |
| Receipts: | - Measure Z Sales Tax Proceeds | | 3,659,676.85 |
| | - Interest Received | | 93,416.72 |
| | FCZC Capital Claim 2022-06C | | (995,699.81) |
| | FCZC Capital Claim 2022-07C | | (1,363,791.05) |
| | Net Increase/(Decrease) to Cash | | 1,393,602.71 |
| | Ending Cash Balance - Available for Capital Projects | | 27,505,607.37 |
| | Ending Balance Available for Operations and Capital Projects | \$ | 34,930,869.54 |
| | Total Interest Received During the Quarter | | 128,653.58 |

By Staff _____

Date _____

Accepted _____

Date _____

* Interest receipts are recorded in the month received rather than in the month earned and were calculated on an annual percentage rate of 1.358 as of June 30, 2022.



**Fresno County Zoo Authority
Treasurer's Report
Unaudited Cash Basis
For the Month Ended September 30, 2022**

| Summary of Measure Z Proceeds | | | |
|--|---|-----|-------------------------|
| Tax Proceeds Received: | | | |
| - | Measure Z - Sales Tax Proceeds | | \$ 1,702,531.63 |
| | Total Proceeds Received: | | \$ 1,702,531.63 |
| Tax Proceeds Allocated: | | | |
| - | Allocation to Zoo Authority Fund (2%) | | 34,050.63 |
| - | Allocation to Trust Fund for Operations and Capital Projects (98%) | | 1,668,481.00 |
| | Total Proceed Allocations | | \$ 1,702,531.63 |
| Cash Balance by Fund | | | |
| Zoo Authority Fund | | | |
| >> Administrative Fund | | 2% | |
| | Beginning Cash Balance | | \$ 2,747,212.79 |
| Receipts: | - Measure Z Sales Tax Proceeds | | 34,050.63 |
| | - Interest Received | | 8,254.38 |
| | - ZA Staff Invoice Reimbursement for Professional Services | | (10,078.55) |
| | Net Increase/(Decrease) to Cash | | 32,226.46 |
| | Ending Cash Balance - Zoo Authority Administrative Fund | | \$ 2,779,439.25 |
| Trust Fund for FCZC Operations and Capital Projects | | | |
| | | 98% | |
| | Beginning Cash Balance | | \$ 35,356,666.97 |
| >>> Operations Fund | | | |
| | Beginning Cash Balance | | 7,686,033.33 |
| Receipts: | - Measure Z Sales Tax Proceeds | | 556,160.33 |
| | - Interest Received | | 24,352.41 |
| Disbursements: | - FCZC Operations Claim #2022-07 | | (841,263.90) |
| | - Wire Fees | | (20.00) |
| | Net Increase/(Decrease) to Cash | | (260,771.16) |
| | Ending Cash Balance - Available for Operations | | \$ 7,425,262.17 |
| >>> Capital Facilities Project Fund | | | |
| | Beginning Cash Balance | | \$ 27,670,633.64 |
| Receipts: | - Measure Z Sales Tax Proceeds | | 1,112,320.67 |
| | - Interest Received | | 86,444.11 |
| Disbursements: | - FCZC Capital Claim 2022-07C | | (1,363,791.05) |
| | Net Increase/(Decrease) to Cash | | (165,026.27) |
| | Ending Cash Balance - Available for Capital Projects | | 27,505,607.37 |
| | Ending Balance Available for Operations and Capital Projects | | \$ 34,930,869.54 |
| | Total Interest Received During the Month | | 119,050.90 |

By Staff _____

Date _____

Accepted _____

Date _____

* Interest receipts are recorded in the month received rather than in the month earned and were calculated on an annual percentage rate of 1.358 as of June 30, 2022.



Fresno County Zoo Authority

SUMMARY OF MEASURE Z SALES TAX PROCEEDS

| | PRIOR FISCAL YEARS | | | CURRENT FISCAL YEAR | | | |
|-----------|------------------------|------------------------|------------------------|--------------------------|------------------------|------------------------------|--------|
| | 2019-2020 | 2020-21 | 2021-22 | 2022-23 | | | |
| | ACTUAL TAX RECEIPTS | ACTUAL TAX RECEIPTS | ACTUAL TAX RECEIPTS | BUDGETED TAX RECEIPTS | ACTUAL TAX RECEIPTS | BUDGET TO ACTUAL VARIANCE | |
| July | \$ 1,436,673 | 1,493,025 | 2,124,574 | \$ 2,188,311 | \$ 2,050,253 | \$ (138,058) | -6.31% |
| August | 1,123,640 | 1,669,386 | 1,637,692 | 1,588,561 | 1,848,761 | 260,200 | 16.38% |
| September | 1,367,439 | 1,417,789 | 1,638,799 | 1,622,411 | 1,702,532 | 80,121 | 4.94% |
| October | 1,571,111 | 1,609,453 | 1,919,542 | | - | 0 | |
| November | 1,073,344 | 1,437,716 | 1,649,471 | | - | 0 | |
| December | 1,194,027 | 1,302,722 | 1,573,898 | | - | 0 | |
| January | 1,263,406 | 1,388,858 | 1,555,927 | | - | 0 | |
| February | 1,707,967 | 1,728,158 | 2,256,736 | | - | 0 | |
| March | 1,063,584 | 1,292,553 | 1,529,499 | | - | 0 | |
| April | 1,031,402 | 1,513,199 | 1,542,639 | | - | 0 | |
| May | 989,444 | 1,632,214 | 1,972,403 | | - | - | |
| June | 1,105,857 | 1,682,042 | 1,712,649 | | - | - | |
| Total | \$ 14,927,894 | 18,167,115 | 21,113,829 | \$ 5,399,283 | \$ 5,601,546 | \$ 202,263 | 3.75% |

TOTAL MEASURE Z PROCEEDS FROM INCEPTION \$ 228,448,778



Fresno County Zoo Authority
Treasurer's Report
Unaudited Cash Basis
For the Month Ended September 30, 2022

| Summary of Quarterly Interest Receipts | | | | | | | | | | | |
|--|----------|-------------------|-------------|---------------|-------------|------------|-------------|------------|-------------|------------|----------------|
| Fund | Subclass | Description | 1st Quarter | | 2nd Quarter | | 3rd Quarter | | 4th Quarter | | Total Interest |
| | | | 1st Alloc. | 2nd Alloc. | 1st Alloc. | 2nd Alloc. | 1st Alloc. | 2nd Alloc. | 1st Alloc. | 2nd Alloc. | |
| Date Received | | | 7/19/2022 | | 9/13/2022 | | | | | | |
| 4845 | 10000 | Zoo Authority | 665.80 | 8,254.38 | - | | | | - | | \$ 8,920.18 |
| 4850 | 10000 | FCZC - Operations | 1,964.27 | 24,352.41 | - | | | | - | | \$ 26,316.68 |
| 4850 | 42700 | FCZC - CP | 6,972.61 | 86,444.11 | - | | | | - | | \$ 93,416.72 |
| Total | | | \$ 9,602.68 | \$ 119,050.90 | \$ - | \$ - | \$ - | \$ - | \$ - | \$ - | \$ 128,653.58 |
| | | | | | | | | | | | |

For Fiscal Year Ending June 30, 2023



**Fresno County Zoo Authority
Capital Projects Fund Cash Flow
For the Month Ended September 30, 2022**

Cash Balance as of 09/30/2022 **\$ 27,505,607**

DEDUCTIONS (earmarked projects, FY22-23 expenditures paid through claim 2022-07C):

| | |
|---|------------------------------|
| Zooplex Construction - June 2020 | 853,317 |
| Asia Construction -July 2020 | 4,007,915 |
| Asia Design - December 2017 | 549,874 |
| Zooplex Design- August 2017 | 103,561 |
| Mixed Species Exhibit Design - June 2021 | 62,963 |
| SLC Biotank Design | 5,530 |
| Mixed Species Exhibit Construction - July 2022 | 29,340 |
| SLC Biotank/Chiller - Construction | 1,409,461 |
| Energy Efficiency | 1,037,674 |
| Total Deductions: | <u><u>\$ (8,059,635)</u></u> |
| TOTAL: | <u><u>\$ 19,445,972</u></u> |



**Fresno County Zoo Authority
Operations Fund Cash Flow
For the Month Ended September 30, 2022**

Cash Balance as of 09/30/2022 **\$ 7,425,262**

DEDUCTIONS (Remaining budgets, paid through claim 2022-07):

| | |
|--------------------------------|------------------------------|
| Marketing | 440 |
| Animal | 1,664,792 |
| Veterinary | 277,955 |
| Utilities | 389,081 |
| Animal Feed | 175,045 |
| Interest/Bank Charges | (60) |
| Maintenance-General Equipment | 20,282 |
| Maint.-Water/Water Standby | 28,064 |
| Visitor Services | 55,050 |
| Commissary | 82,812 |
| Maintenance | 33,073 |
| Medical, Dental & Lab Supplies | 27,142 |
| Total Deductions: | <u><u>\$ (2,753,676)</u></u> |
| TOTAL: | <u><u>\$ 4,671,586</u></u> |



**Fresno County Zoo Authority
Administration Fund Cash Flow
For the Month Ended September 30, 2022**

Cash Balance as of 09/30/2022 \$ 2,779,439

DEDUCTIONS

(FY 22-23 Remaining budgets, ZA Claim paid through September 30, 2022):

| | |
|--------------------------------|---------|
| Telephone Charges | 250 |
| Memberships | 500 |
| Office Expense | 6,000 |
| Postage | 1,000 |
| PeopleSoft Financials Charges | 731 |
| Professional & Specialized Ser | 150,403 |
| Data Processing Services | 1,500 |
| Publications & Legal Notices | 500 |
| Trans, Travel & Education | 2,500 |

| | |
|--------------------------|---------------------|
| Total Deductions: | <u>\$ (163,384)</u> |
|--------------------------|---------------------|

| | |
|---------------|----------------------------|
| TOTAL: | <u><u>\$ 2,616,055</u></u> |
|---------------|----------------------------|



AGENDA ITEM 6

DATE: October 26, 2022

TO: Fresno County Zoo Authority Board

FROM: Jon Forrest Dohlin, Chief Executive Officer
Fresno Chaffee Zoo Corporation

SUBJECT: Zoo Director's Report

RECOMMENDED ACTION:

Receive Fresno Chaffee Zoo Director's report.

AGENDA ITEM 7



Master Plan

June 2022



MISSION



*We inspire people to care for animals, create connections,
build community, and save wildlife.*

VISION



*A just future that begins with us and makes possible a world
where people and wildlife thrive together.*



We inspire people to care for animals, create connections, build community, and save wildlife.

SAVING WILDLIFE

BUILDING TEAMS

RESPONSIBLE
BUSINESS

STRENGTHENING
COMMUNITY

Our Core Values:

- **United:** *We are one team, working together to support our mission, communities, and each other.*
- **Dedicated:** *We are knowledgeable and passionate, driven to improve, grow, and learn.*
- **Respectful:** *We show respect for one another and the unique contributions we each make to our institution.*
- **Grateful:** *We appreciate the support of our community, the people we work with, and the treasures of the natural world.*
- **Welcoming:** *We work to ensure that everything we do is accessible and inclusive of all.*
- **Aspirational:** *Through our work, we will have a positive impact on nature, people, and wildlife.*

Master Plan

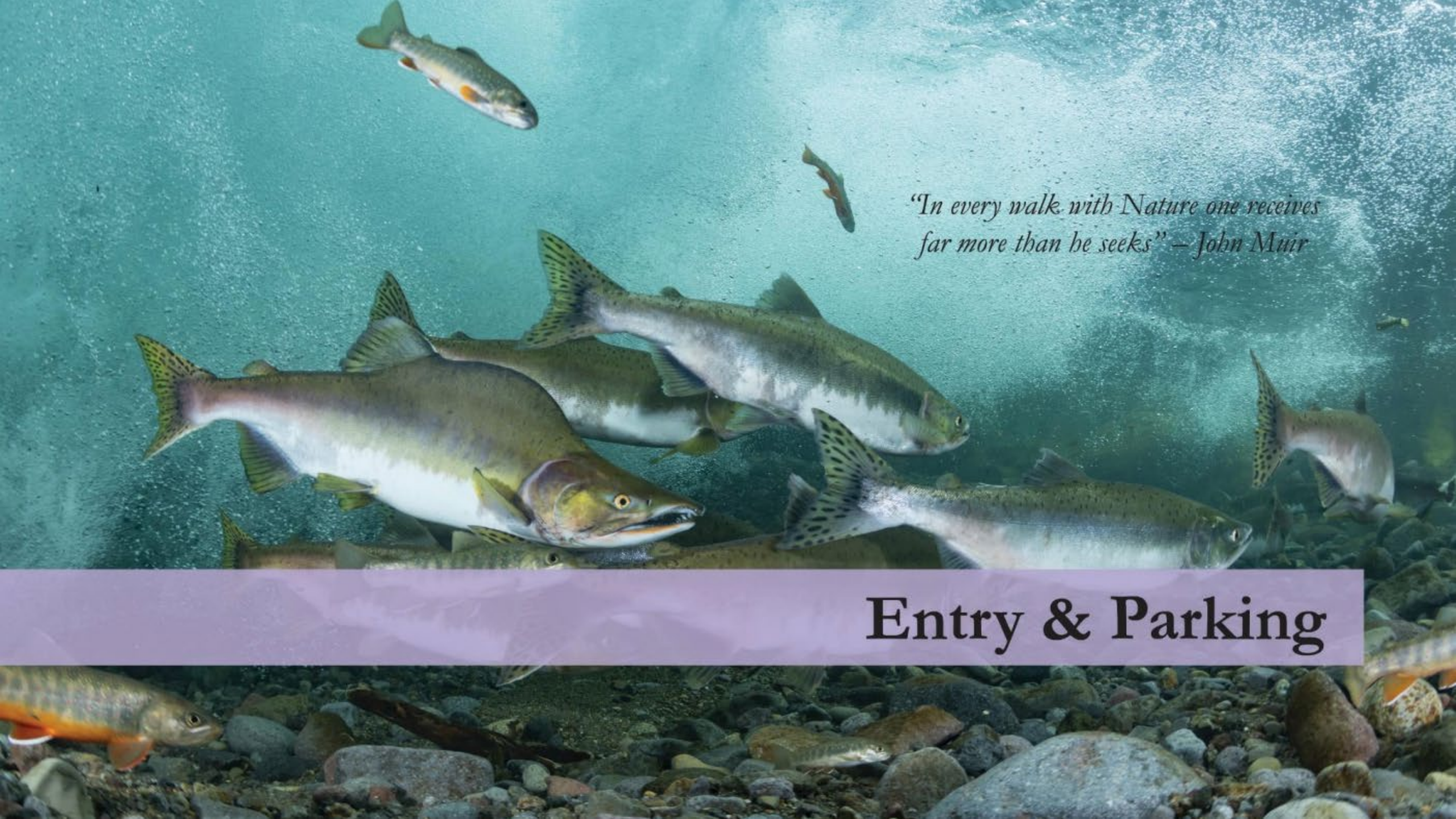

An underwater photograph of several salmon swimming in a river. The water is clear and blue-green. The salmon are silvery with some orange and yellow markings. They are swimming towards the right. The riverbed is covered with dark, smooth rocks. The lighting is bright, creating a shimmering effect on the water's surface.

*"In every walk with Nature one receives
far more than he seeks" — John Muir*

Entry & Parking

Entry & Parking



Entry & Parking

Overview

The new entry to the Peacock Zoo is located in the General Entry at California. Drawing inspiration from the existing far design, the new entry will connect the existing parking area around the Zoo with new parking garages. Together, they create a new, shaded route to an improved new entry and arrival plaza that establish a new sense of place and a welcoming atmosphere. The new entry reorganizes the landscape, including landscaping, guest services, concessions, and retail, preparing the Zoo to handle more than one million visitors a year.

Program

| | |
|------------------|------------|
| Parking Garage 1 | 300 Spaces |
| Parking Garage 2 | 300 Spaces |
| Annual Plaza | 6,500 SF |
| Retail | 5,100 SF |
| Guest Services | 3,800 SF |
| Monumentation | 0 |





Rice University Cambridge Office Garage, Houston, TX

- Tensile Mesh Facade, Custom Printed with Leaf Pattern Image



T3 Parking Structure, Austin, TX

- Living Vegetation Facade



San Antonio Zoo Parking Garage, San Antonio, TX

- Living Vegetation Facade
- Zoo Sign



Crocker Park Parking Garage, Westlake, OH

- Tensile Mesh Facade, Custom Printed with Tree Pattern Image



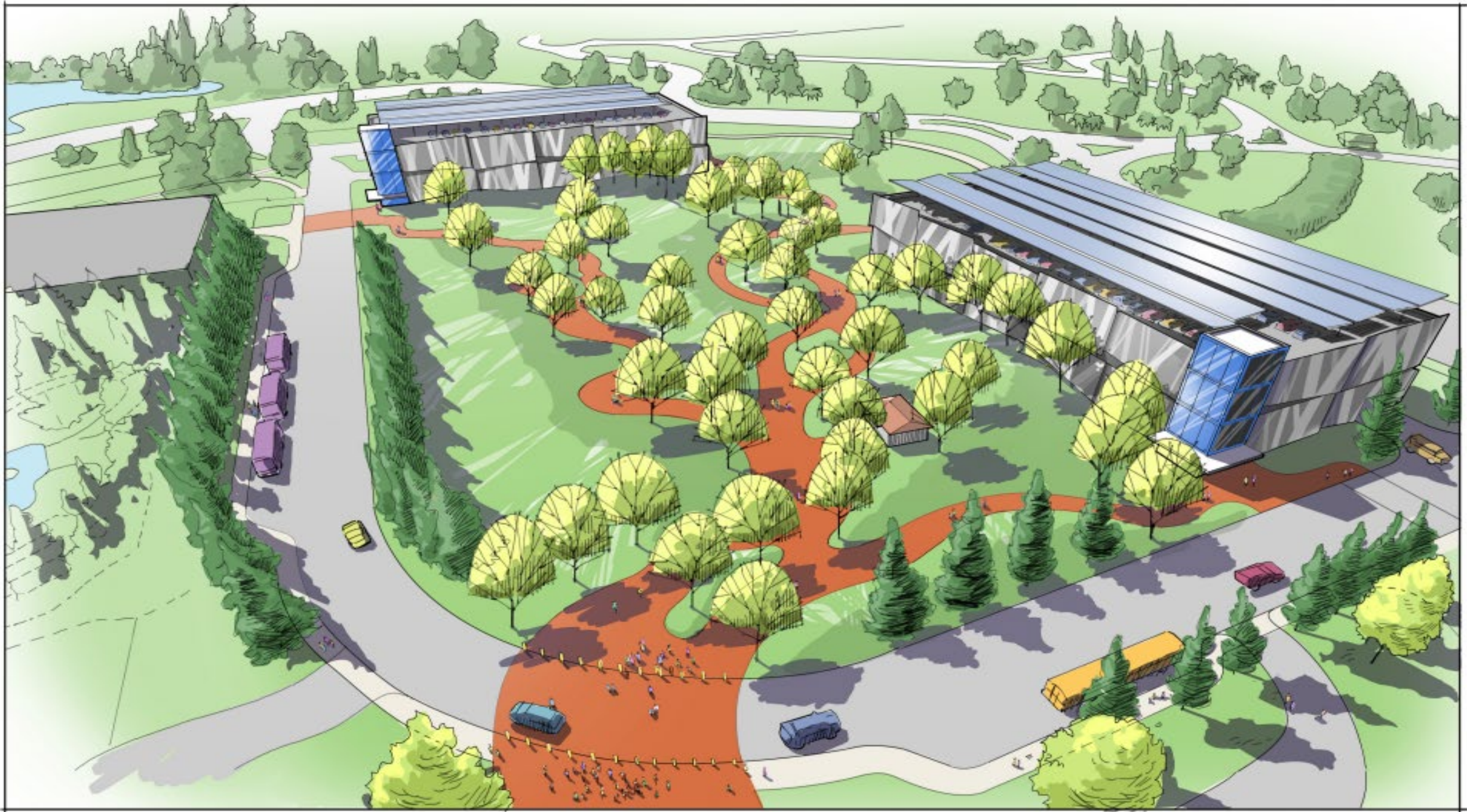

Lawson Lane Campus, Milpitas, CA

- Bronze Mesh



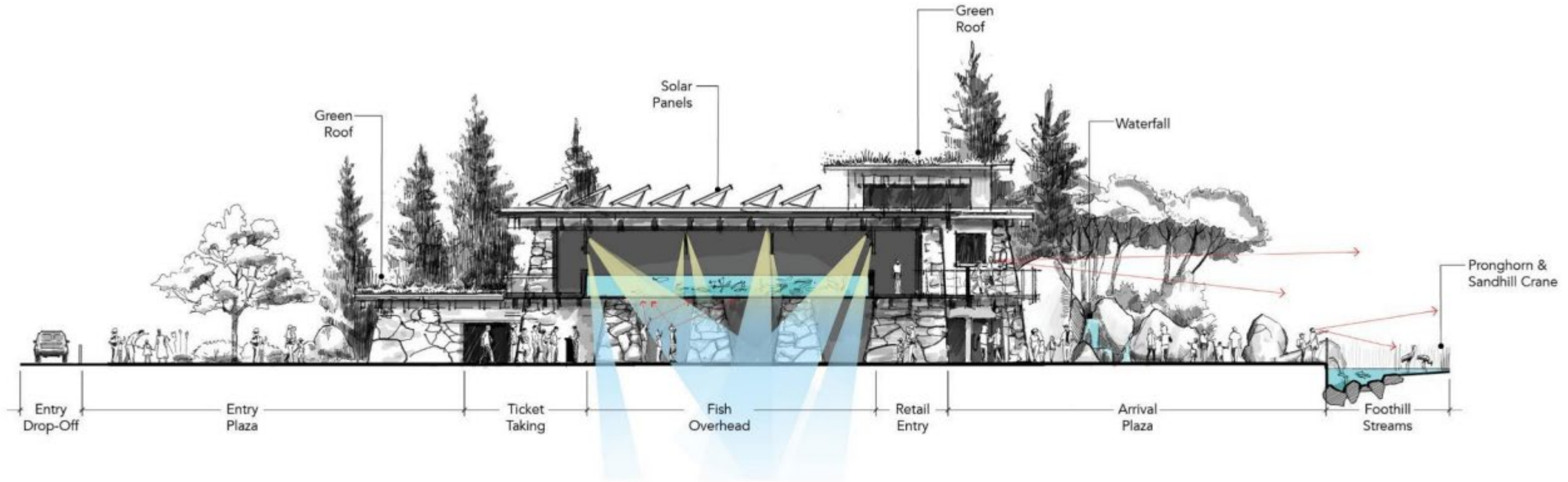



A close-up photograph of two coyotes howling. The coyote in the foreground is in sharp focus, its head tilted back and mouth wide open, showing its teeth and tongue. Its fur is a mix of grey, brown, and white. The second coyote is in the background, slightly out of focus, also howling with its mouth open. The background is a dark, blurred green and brown, suggesting a natural habitat.

“...A landscape was displayed that after all my wanderings still appears as the most beautiful I have ever beheld. At my feet lay the Great Central Valley of California, level and flowery, like a lake of pure sunshine” – John Muir

California

California



The California Coast



ANIMALS:
California sea lion
Harbor seal

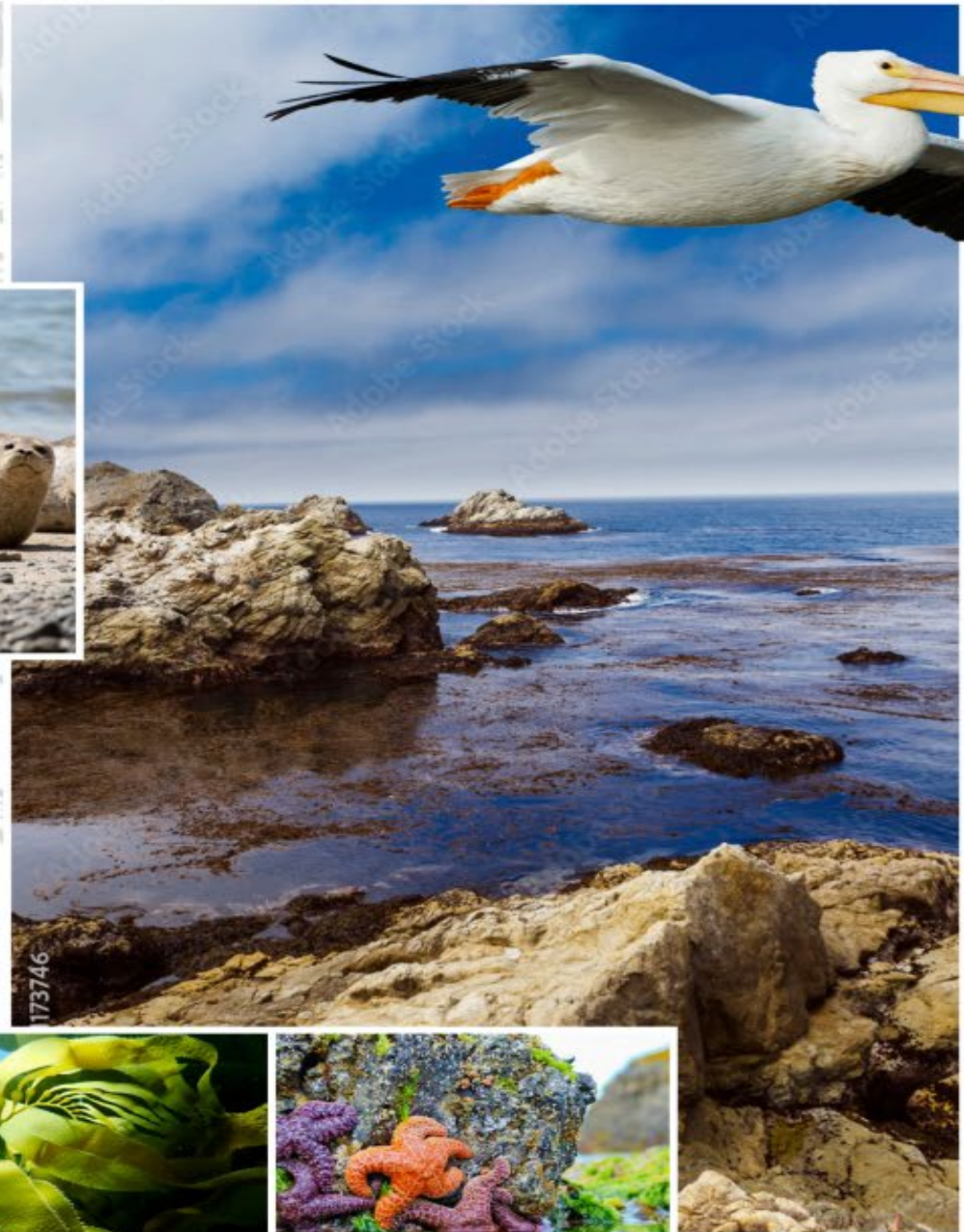

The Coastal Mountains

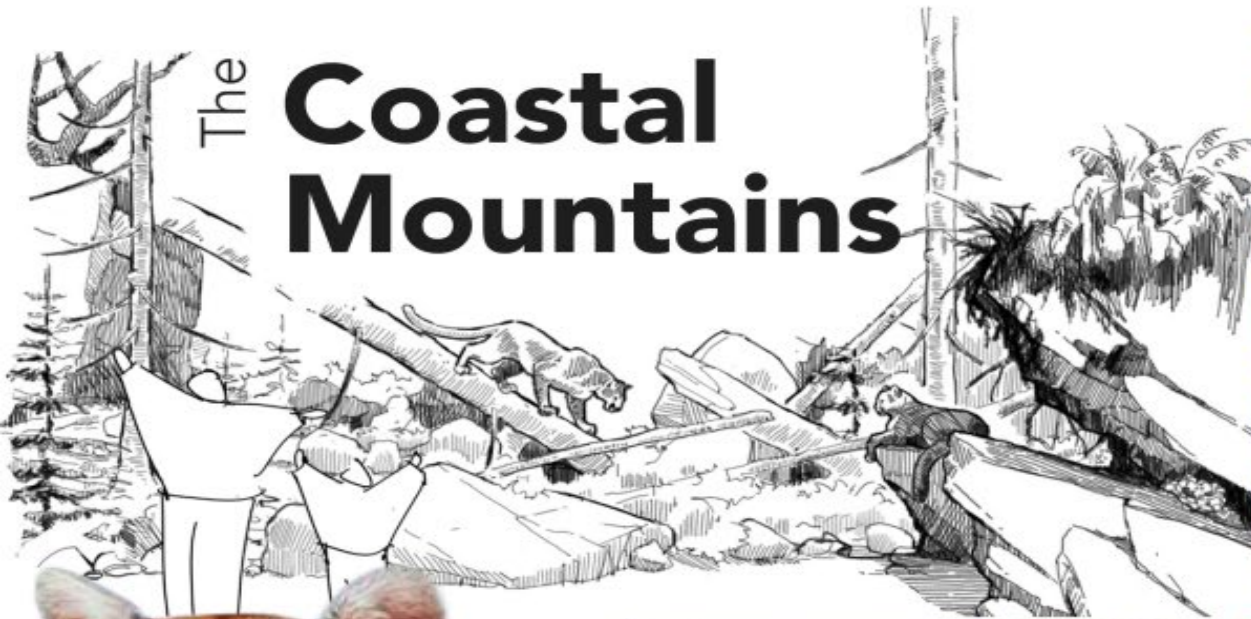

ANIMALS:

Mountain Lion
Ensatina
Coastal giant salamander
Black salamander
Ringneck snake
Foothill yellow-legged frog
California red legged frog
Banana slug
Rubber boa
Mountain kingsnake



The San Joaquin Valley

Grasslands & Wetlands

ANIMALS:

San Joaquin kit fox
Tricolored blackbird
Rails
Heron
California black crane
Shrike
Western pond turtle
Giant garter snake
Red sided garter snake
Red legged frog



Rivers and Streams

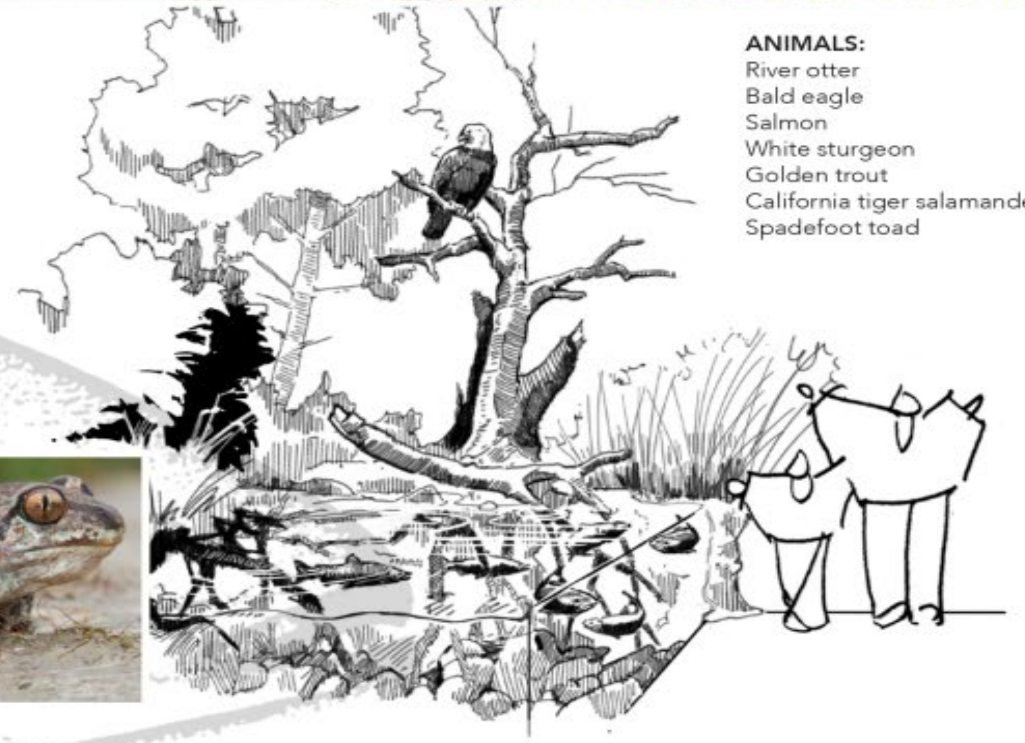

ANIMALS:
River otter
Bald eagle
Salmon
White sturgeon
Golden trout
California tiger salamander
Spadefoot toad



#111709774

The Sierra Foothills



ANIMALS:

Wolf
Pronghorn
Sandhill crane
Blunt nose leopard lizard
Coast Horned lizard
Kangaroo rats
Coachwhips
Burrowing Owl
Grey Fox



A large, sleek shark, likely a Great White, is the central focus, swimming towards the left. Its mouth is slightly open, revealing rows of sharp teeth. The background is a deep blue ocean with various smaller fish and marine life visible. The lighting is natural, suggesting an underwater environment.

*"If my soul could get away...I should
follow magnetic streams to their source
and follow the shores of our magnetic
oceans" — John Muir*

Pacific Rim Aquarium

Pacific Rim Aquarium

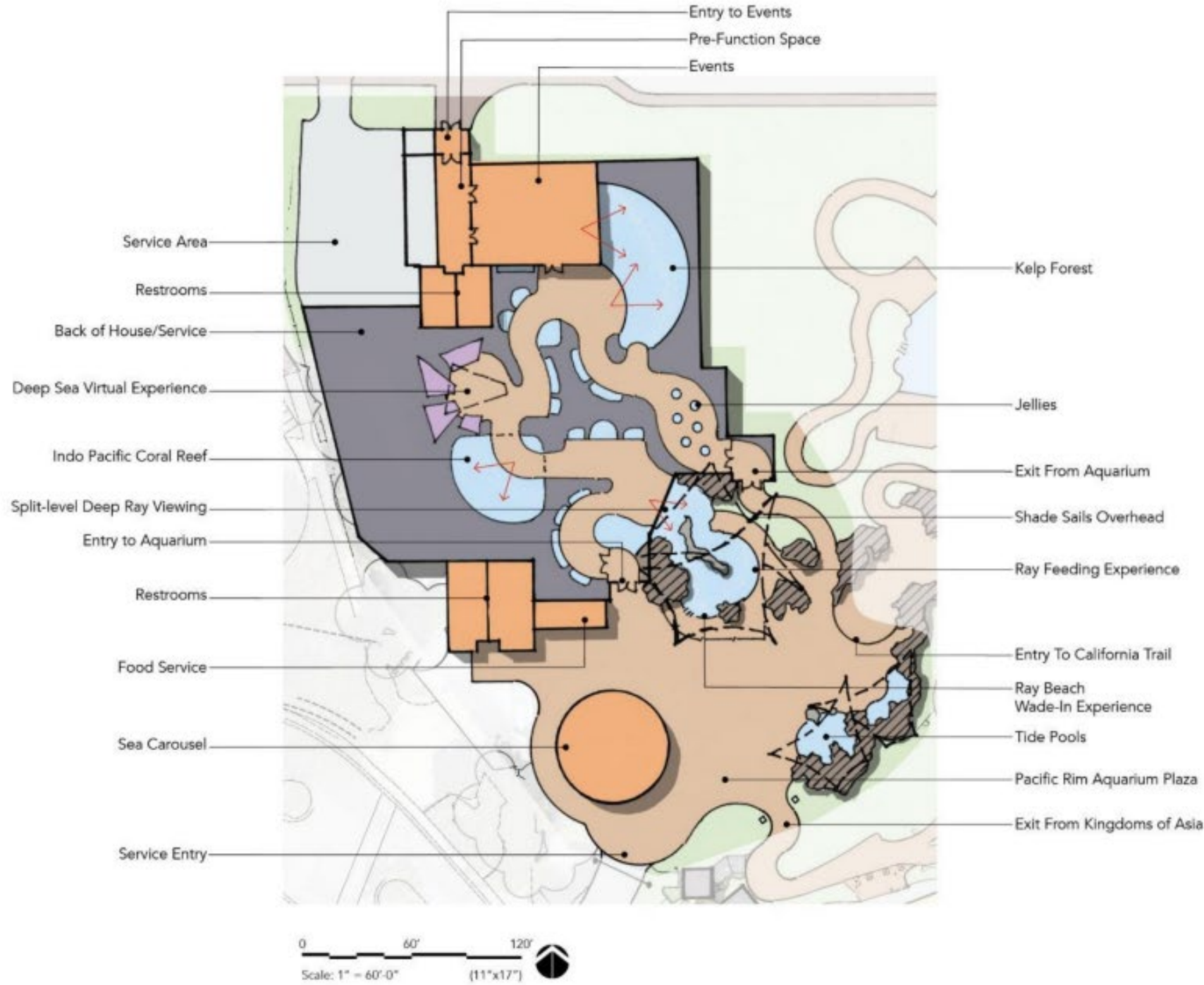



Kelp Forest



Sea Horses



Ray Wade-in



Jellies



*“When we try to pick out anything by
itself, we find it hitched to everything else
in the Universe” – John Muir*

Events & Education

Events and Education



A close-up photograph of two lemurs, likely ring-tailed lemurs, looking out from a rocky ledge. The lemur on the left is in profile, facing right, with its head slightly turned towards the camera. The lemur on the right is facing forward, looking directly at the camera. Both have grey faces with white markings around their eyes and on their heads. They have large, bright orange eyes and black noses. The background is a soft, out-of-focus green, suggesting a natural habitat. A purple banner is at the bottom of the image.

*“The world’s big and I want to have
a good look at it before it gets dark”
— John Muir*

Conservation Corridor

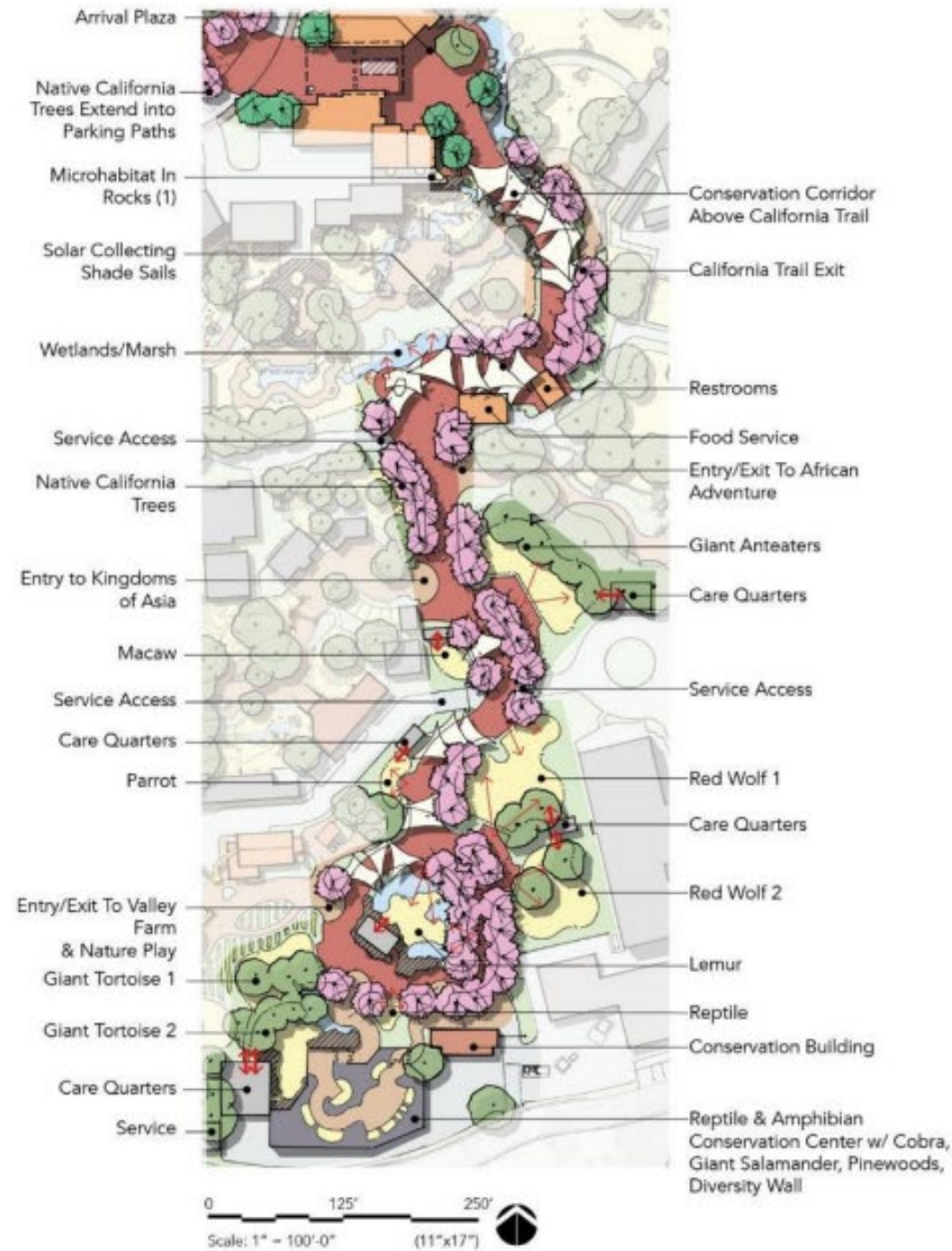

Conservation Corridor





Lemur Habitat

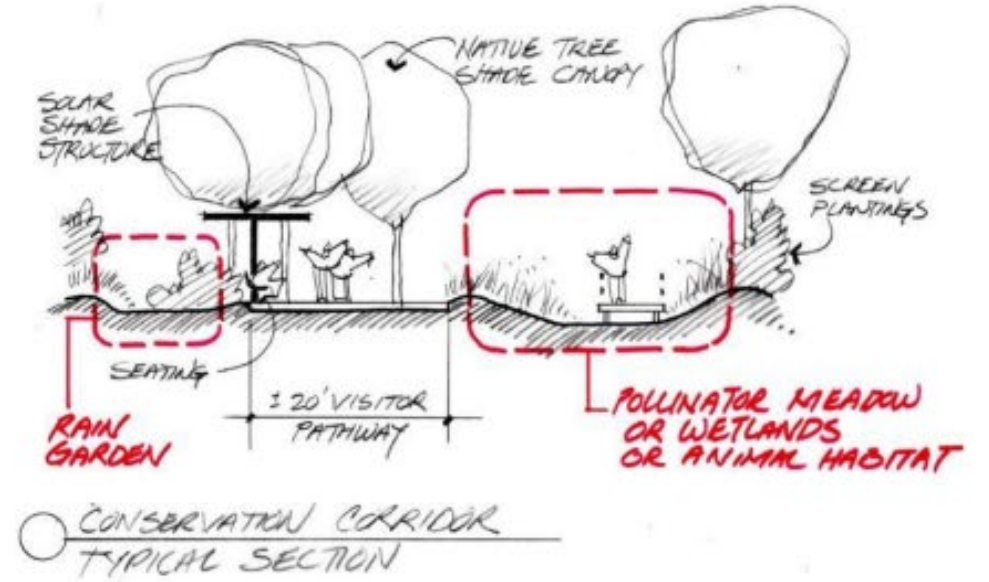

Typical Cross Section Through Conservation Corridor



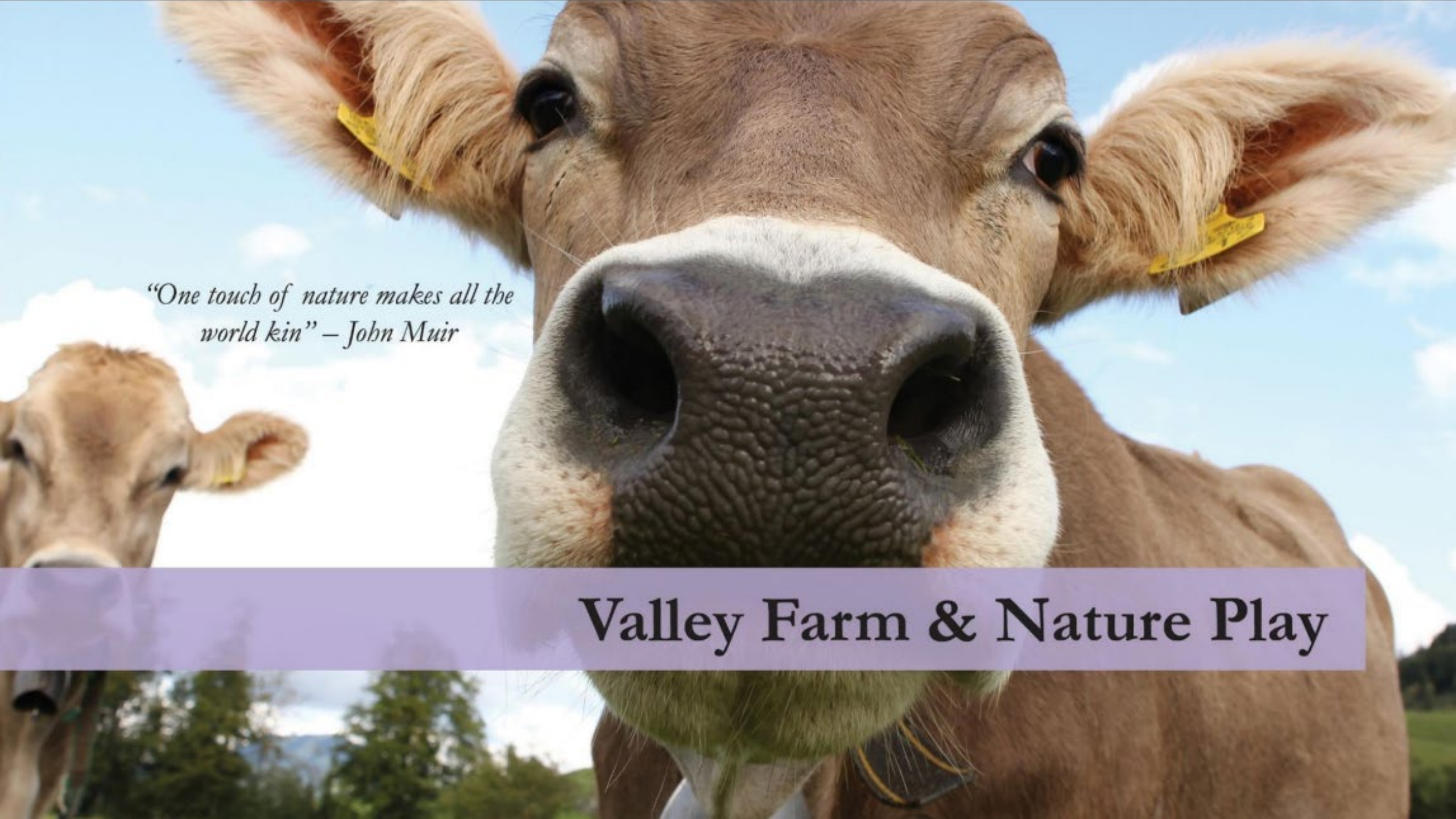

*“One touch of nature makes all the
world kin” – John Muir*

Valley Farm & Nature Play

Valley Farm and Nature Play

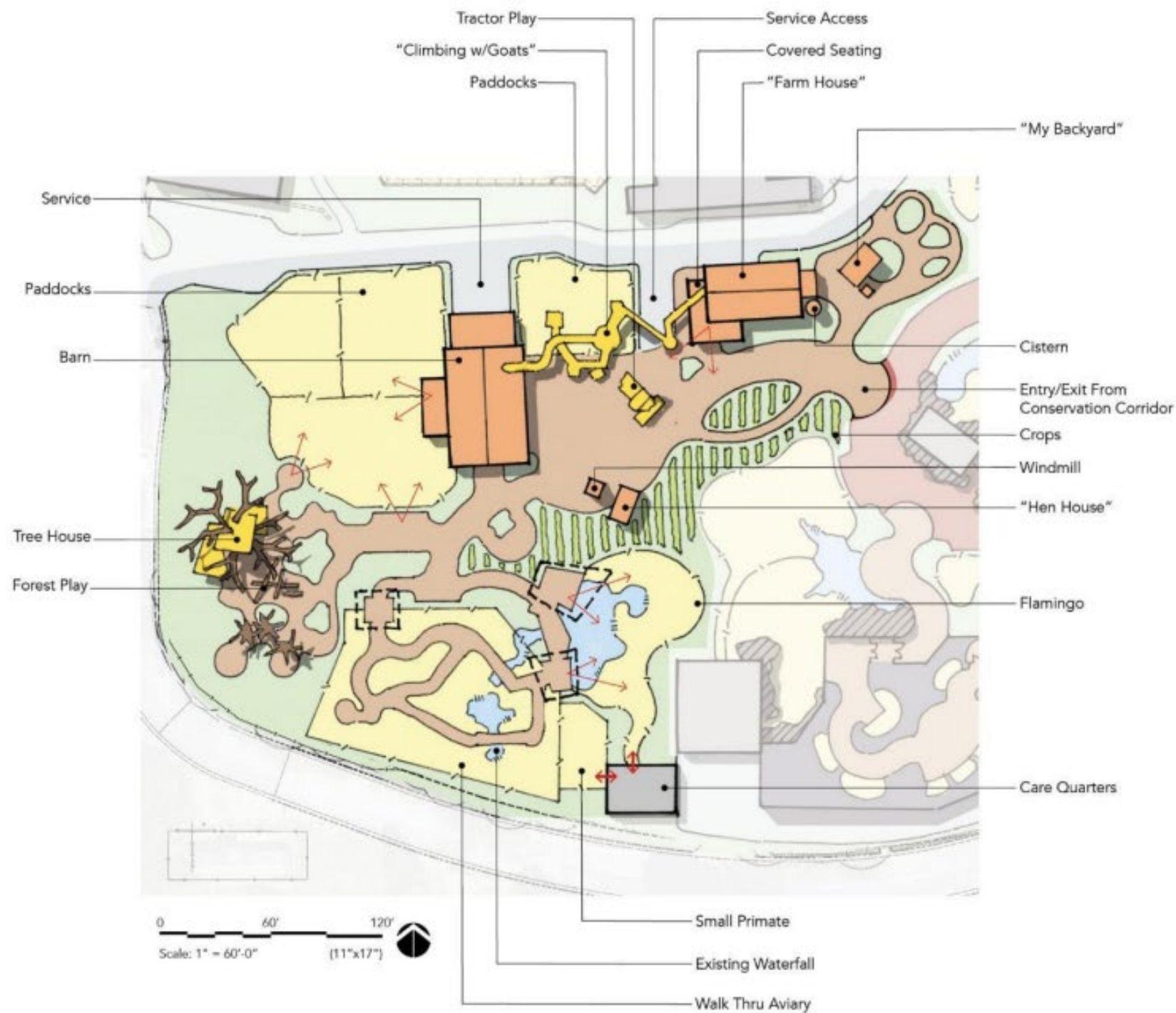

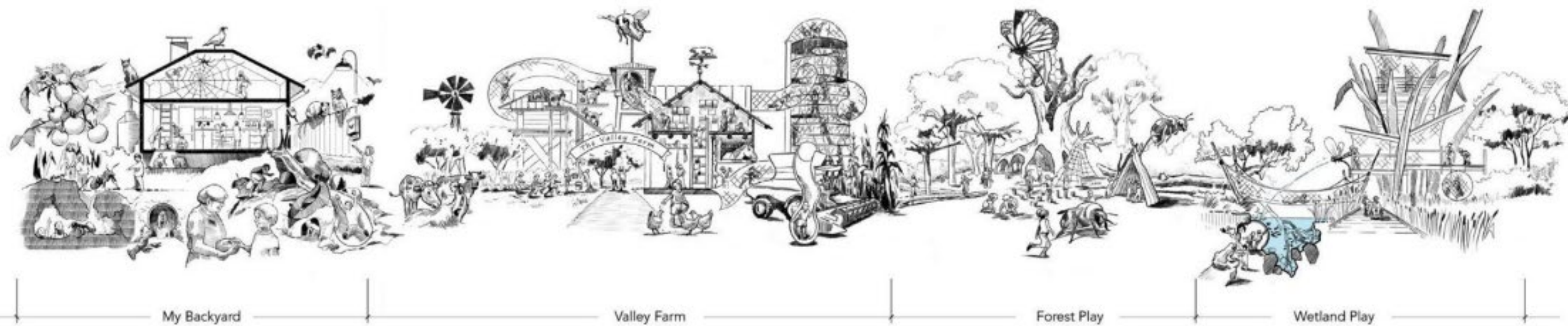

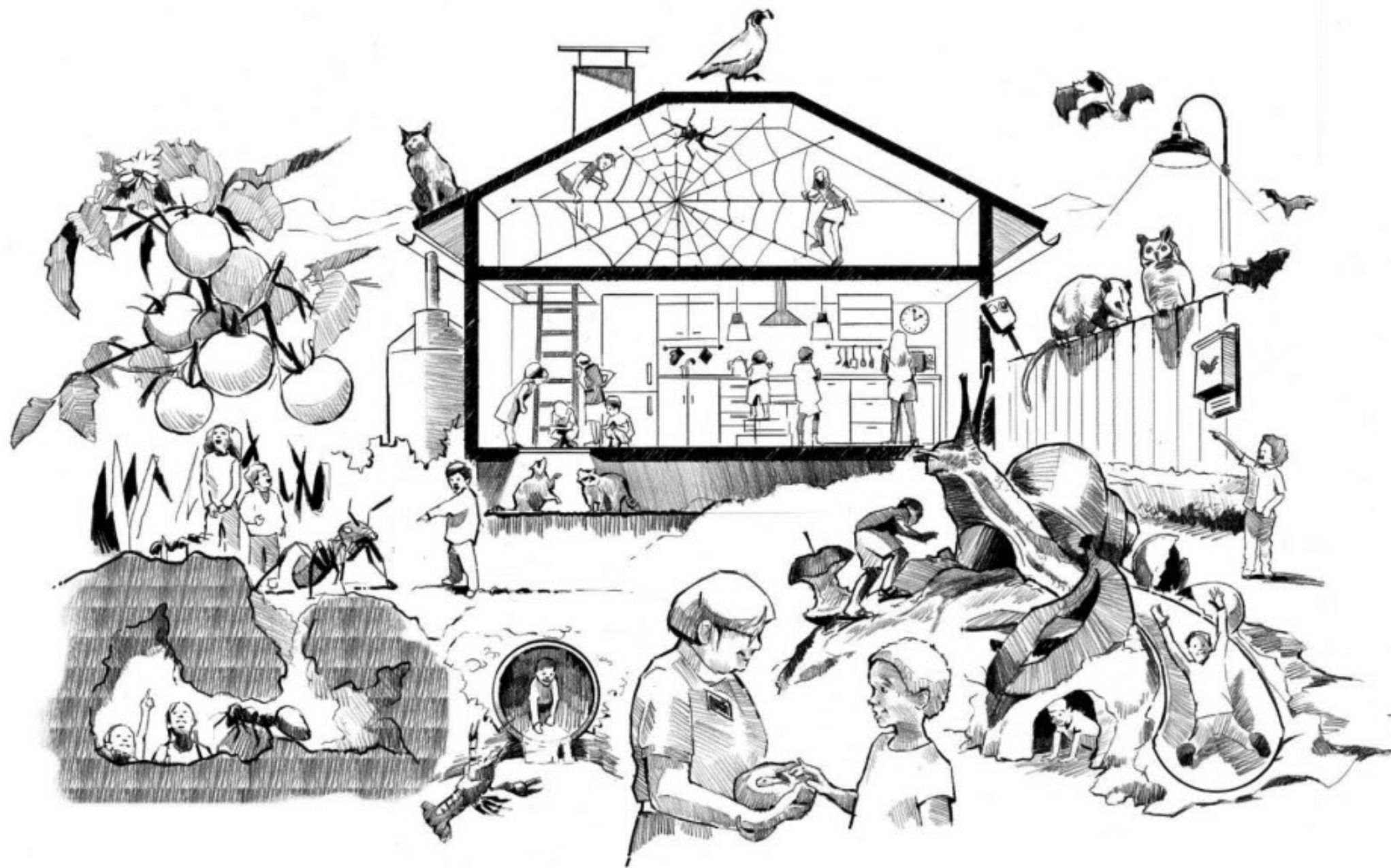

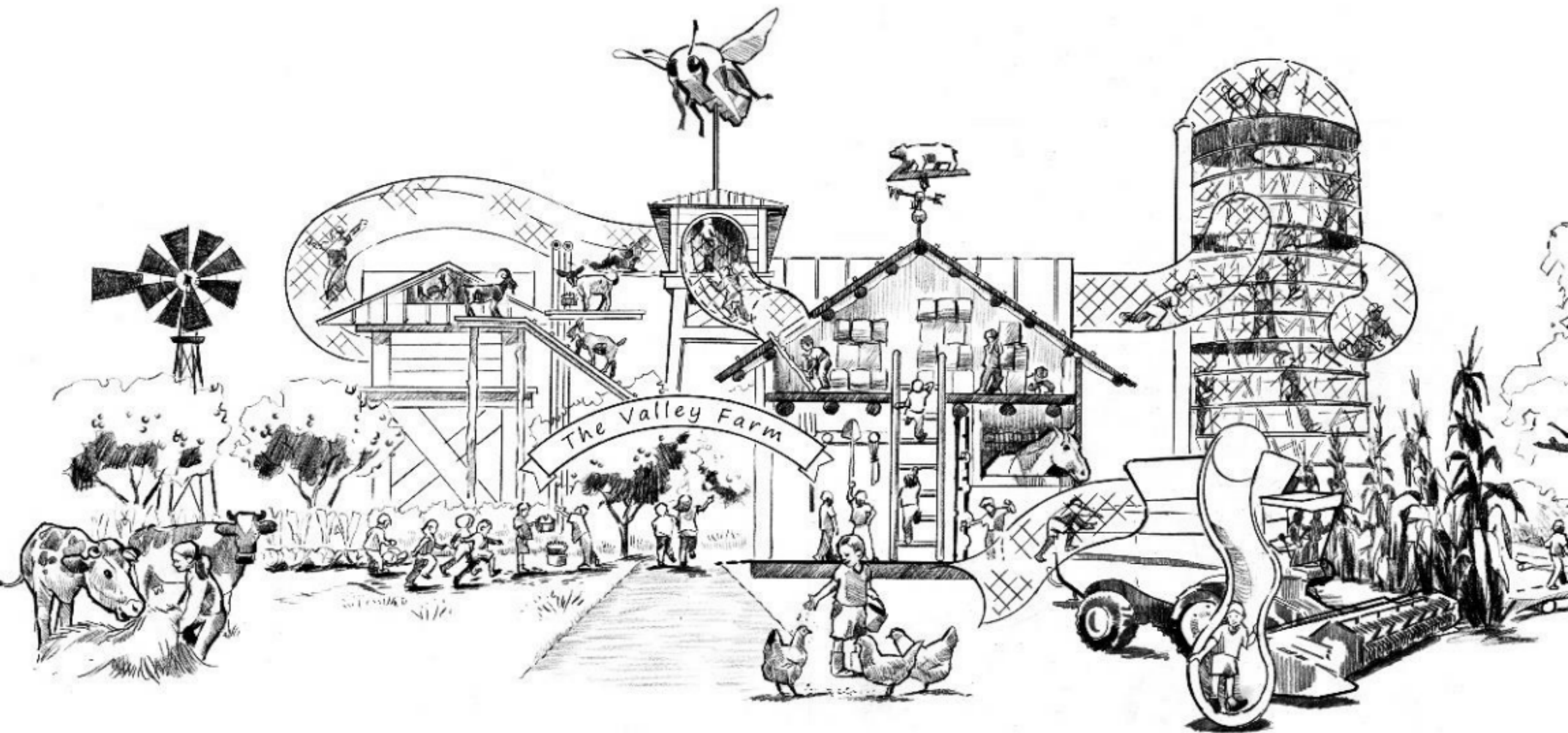



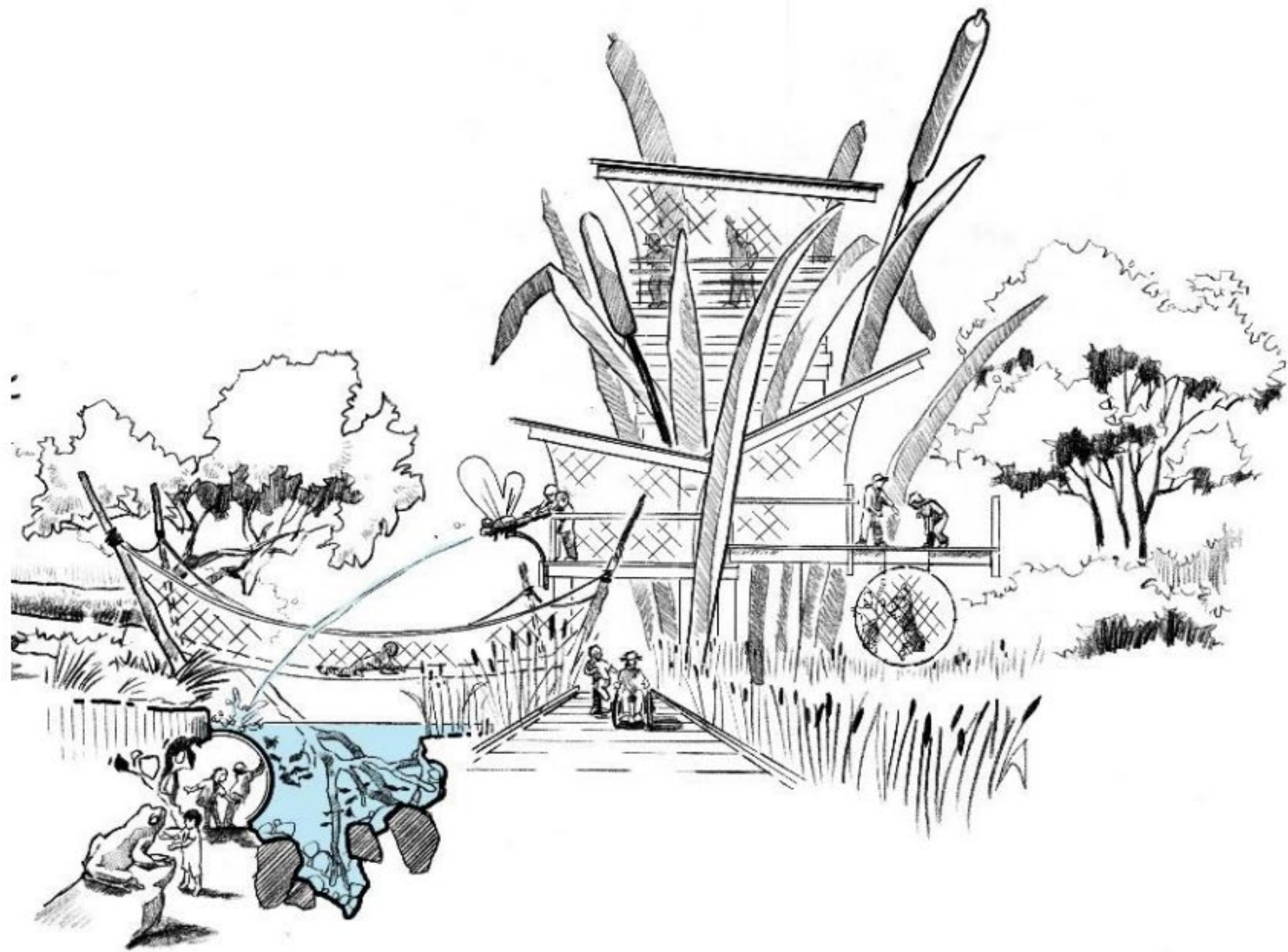



Support Facilities

Service Program Plan

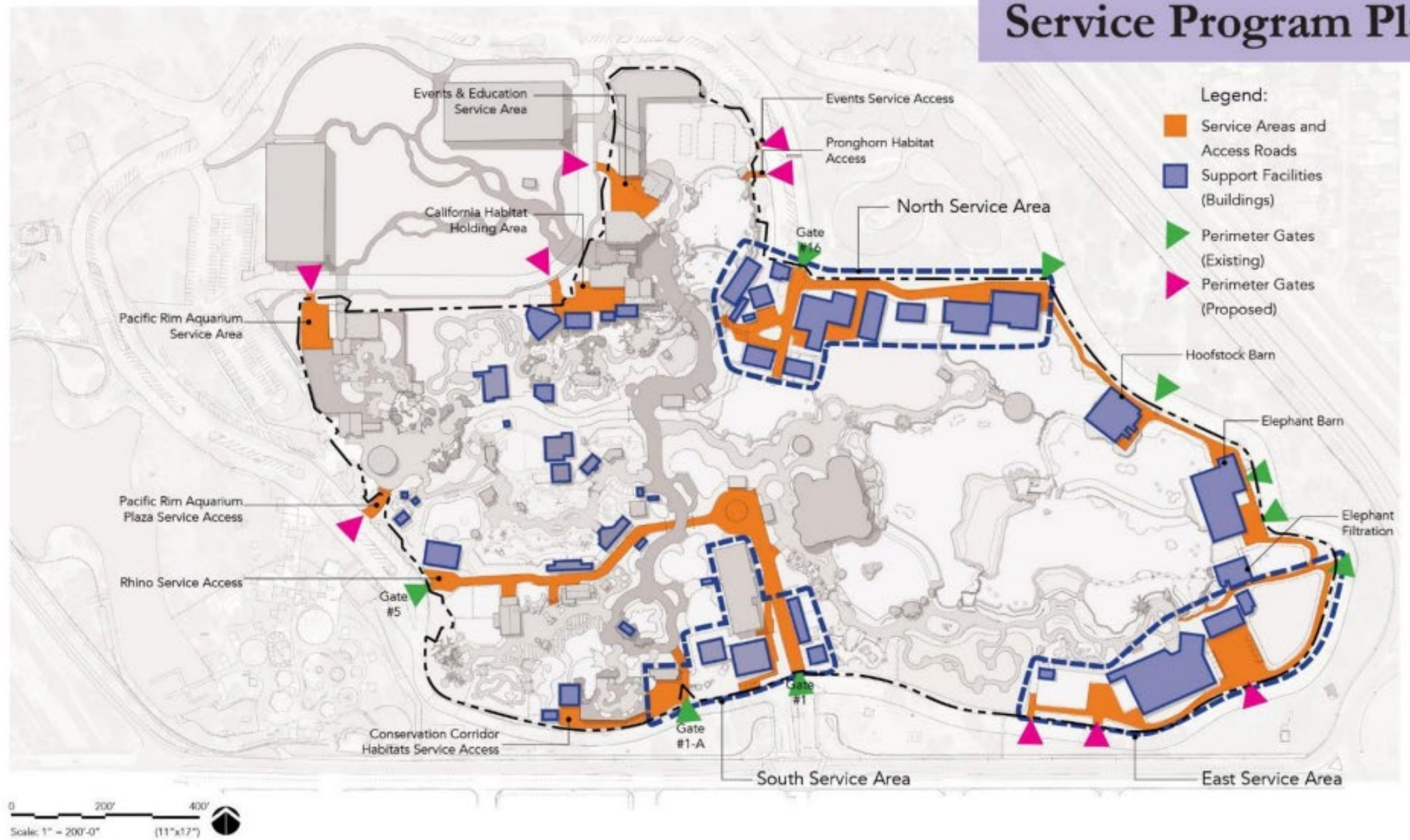

North Service Area



East Service Area

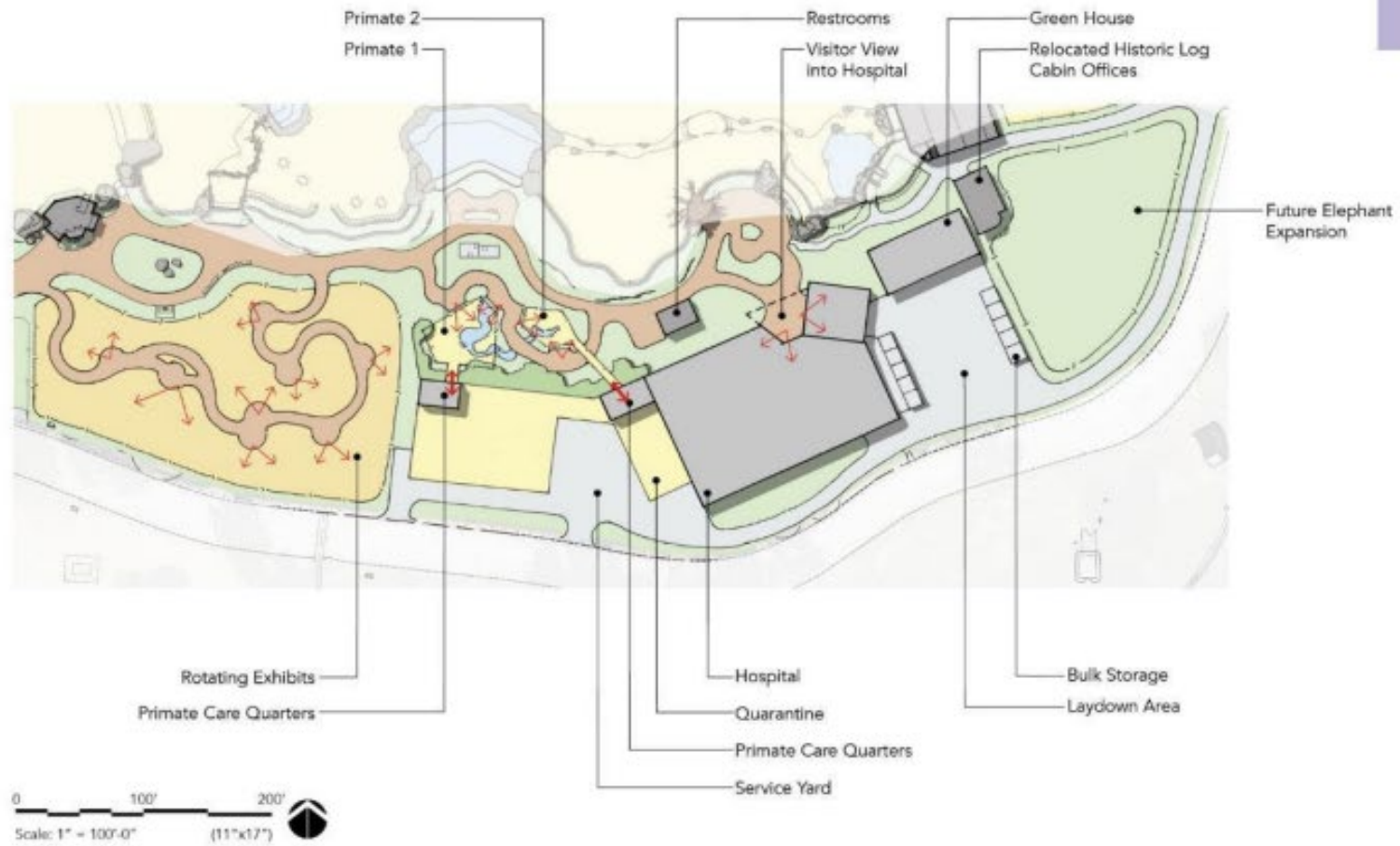

South Service Area





Making it Happen

Master Plan Projects

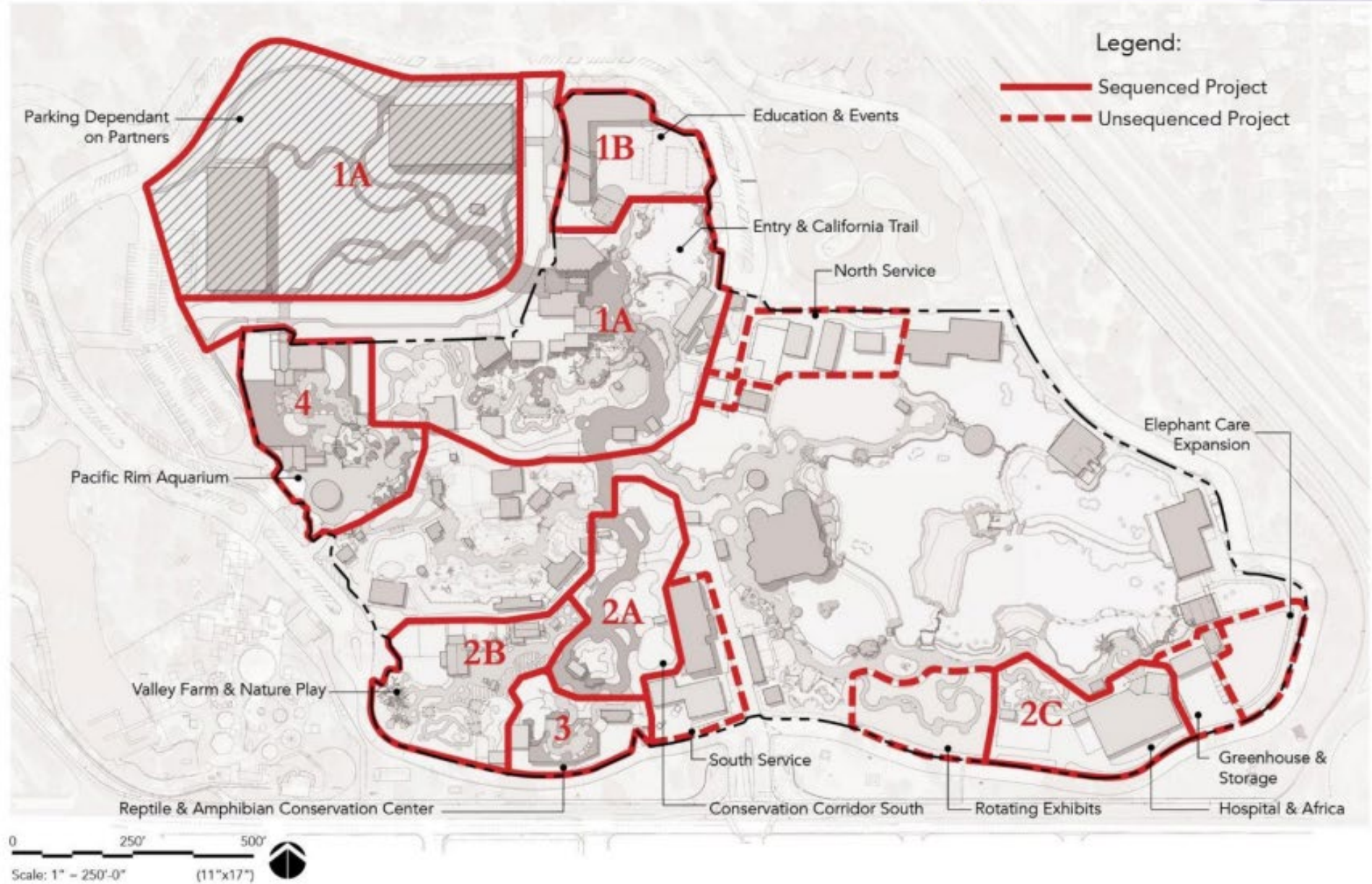

Master Plan





AGENDA ITEM 8

DATE: October 26, 2022

TO: Fresno County Zoo Authority Board

FROM: Nora Crow, Chief Financial Officer
Fresno Chaffee Zoo Corporation

SUBJECT: August 2022 Year-to-Date Financial Report

RECOMMENDED ACTION:

Receive Fresno Chaffee Zoo Corporation's August 2022 Year-to-Date Financial Report and September 2022 Early Insights.

ATTACHMENTS:

August 2022 Financial Report



Financial Report

August 2022 YTD

September 2022 Early Insights

Summary

August 2022

Key Takeaway: Attendance has been above budget each month,; attendance was 5,122 for summer camps; through our partnership with OneFresno & the Housing Authority 4,863 people visited the zoo year to date.

- \$10,603,568 self-generated revenue YTD (15% above budget)
- \$13,771,693 total expenses (8% below budget)
- \$3,168,125 operating deficit (less than budgeted deficit of \$5,792,016)
- \$1,921,560 operating surplus with Measure Z support (budgeted deficit of \$365,672)
- **\$9,595,161 net surplus – MZ Capital Funds, Depreciation, Investment Income/Interest**

September 2022 Key Notes:

- Very early preliminary self-generated year to date revenue is \$11.1m compared to budget of \$10.m (not including interfund operational support)
- Attendance was 4,863 YTD through our partnership with OneFresno and the Housing Authority.
- Record breaking temperatures in early September of 104+ weather hampered attendance, causing September to be the first month this year to be under budget.

2022 – Attendance

August 2022 = 45,295 (88% of 2019, 106% of budget)

August 2022 YTD attendance = 640,697 (110% of 2019, 126% of budget)

September 2022 YTD attendance = 675,496 (105% of 2019, 120% of budget)

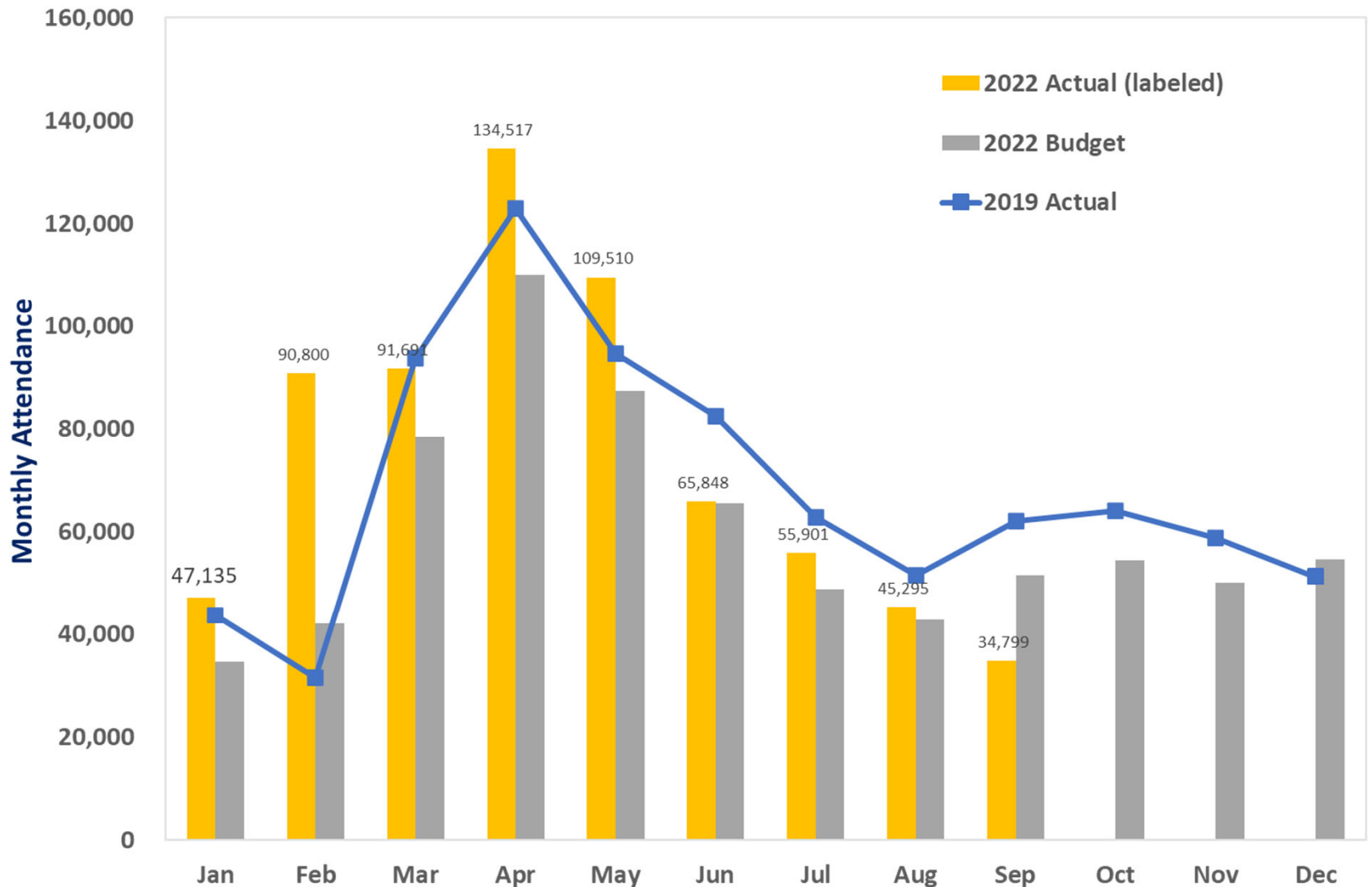

Aug '22 YTD – Variance Analysis vs. Budget

| Summary | FY 22 Actual | FY 22 Budgeted | FY 22 Diff. | % Diff. | FY 21 Actual | FY 21 Diff. | % Diff. |
|-----------------------------------|---------------|----------------|-------------|---------|--------------|----------------|---------|
| Attendance | 45,295 | 42,700 | 2,595 | 6% | 55,488 | (10,193) | (18%) |
| Revenue | \$10,603,568 | \$9,182,005 | \$1,421,563 | 15% | \$10,267,814 | \$335,754 | 3% |
| Personnel Expenses | \$8,154,579 | \$8,989,649 | (\$835,070) | (9%) | \$6,520,473 | \$1,634,106 | 25% |
| Other Expenses | \$5,617,113 | \$5,984,372 | (\$367,259) | (6%) | \$4,375,809 | \$1,241,305 | 28% |
| Operations Surplus (Deficit) | (\$3,168,125) | (\$5,792,016) | \$2,623,891 | 45% | (\$628,468) | (\$2,539,657) | (404%) |
| Measure Z Operating | \$5,089,685 | \$5,426,344 | (\$336,659) | (6%) | \$2,046,252 | \$3,043,432 | 149% |
| Operations + MZ Surplus (Deficit) | \$1,921,560 | (\$365,672) | \$2,287,232 | nm | \$1,417,784 | \$503,775 | 36% |
| Other Non-Operating | \$7,673,602 | \$543,089 | \$7,130,513 | nm | \$19,431,848 | (\$11,758,247) | (61%) |
| Net Surplus (Deficit) | \$9,595,161 | \$177,417 | \$9,417,744 | 5308% | \$20,849,632 | (\$11,254,471) | (54%) |

| Revenue - Selected Detail | FY 22 Actual | FY 22 Budgeted | FY 22 Diff. | % Diff. | FY 21 Actual | FY 21 Diff. | % Diff. |
|--------------------------------|--------------|----------------|-------------|---------|--------------|-------------|---------|
| Admissions | \$3,792,175 | \$3,661,867 | \$130,308 | 4% | \$4,182,081 | (\$389,906) | (9%) |
| Membership | \$1,706,745 | \$1,452,000 | \$254,745 | 18% | \$1,863,026 | (\$156,281) | (8%) |
| Food Services/Gift Shop | \$1,163,268 | \$1,028,786 | \$134,482 | 13% | \$1,203,986 | (\$40,718) | (3%) |
| Dinosaur Exhibit | \$1,108,149 | \$1,236,600 | (\$128,451) | (10%) | \$1,274,066 | (\$165,917) | (13%) |
| Grants/Fundraising, ex-bequest | \$192,565 | \$350,000 | (\$157,435) | (45%) | \$131,682 | \$60,883 | 46% |
| Bequest - unrestricted | - | nm | nm | nm | | nm | nm |
| Other | \$2,640,667 | \$1,452,752 | \$1,187,915 | 82% | \$1,612,973 | \$1,027,694 | 64% |
| Revenue | \$10,603,568 | \$9,182,005 | \$1,421,563 | 15% | \$10,267,814 | \$335,754 | 3% |

| Expenses - Selected Detail | FY 22 Actual | FY 22 Budgeted | FY 22 Diff. | % Diff. | FY 21 Actual | FY 21 Diff. | % Diff. |
|----------------------------|--------------|----------------|---------------|---------|--------------|-------------|---------|
| Personnel - Animal/Vet. | \$3,038,792 | \$3,447,717 | (\$408,925) | (12%) | \$2,773,908 | \$264,884 | 10% |
| Personnel - Education | \$1,193,126 | \$923,495 | \$269,631 | 29% | \$876,252 | \$316,874 | 36% |
| Personnel - Maint./Hort. | \$806,549 | \$1,126,788 | (\$320,239) | (28%) | \$609,952 | \$196,596 | 32% |
| Personnel - Other | \$3,116,113 | \$3,491,649 | (\$375,536) | (11%) | \$2,260,361 | \$855,752 | 38% |
| Animal Services | \$385,499 | \$436,464 | (\$50,965) | (12%) | \$337,606 | \$47,892 | 14% |
| Dinosaur Exhibit | \$543,790 | \$534,234 | \$9,556 | 2% | \$440,990 | \$102,799 | 23% |
| Utilities | \$618,968 | \$627,000 | (\$8,032) | (1%) | \$494,287 | \$124,681 | 25% |
| Repairs & Replacements | \$304,844 | \$543,763 | (\$238,919) | (44%) | \$485,608 | (\$180,764) | (37%) |
| Contracted/Prof. Services | \$981,321 | \$767,855 | \$213,466 | 28% | \$564,250 | \$417,070 | 74% |
| Conservation | \$157,866 | \$175,900 | (\$18,034) | (10%) | \$13,053 | \$144,814 | 1109% |
| Accumulated Op Ex - Other | \$2,624,826 | \$2,899,156 | (\$274,330) | (9%) | \$2,040,014 | \$584,812 | 29% |
| Operating Expenses | \$13,771,693 | \$14,974,021 | (\$1,202,328) | (8%) | \$10,896,282 | \$2,875,411 | 26% |

Per Capita Spending on Grounds (1 of 3)

Price Reference

| Selected Ticket Prices | Non-Member | | | | Member | | | |
|------------------------|------------|---------|---------|---------|--------|--------|--------|--------|
| | 2022 | 2021 | 2020 | 2019 | 2022 | 2021 | 2020 | 2019 |
| Adult Ticket | \$14.95 | \$14.95 | \$14.95 | \$12.95 | - | - | - | - |
| Child Ticket | \$8.95 | \$8.95 | \$8.95 | \$7.95 | - | - | - | - |
| Giraffe Feeding | \$5.00 | \$5.00 | \$3.00 | \$3.00 | \$3.00 | \$3.00 | \$3.00 | \$3.00 |
| Stingray Bay Admission | \$4.00 | \$4.00 | \$2.00 | \$2.00 | - | - | - | - |
| Stingray Bay Feeding | \$2.00 | \$2.00 | \$2.00 | \$1.00 | \$2.00 | \$2.00 | \$2.00 | \$1.00 |
| Adult Zoorassic Park | \$6.00 | \$6.00 | \$5.00 | \$4.00 | \$5.00 | \$5.00 | \$5.00 | \$4.00 |
| Child Zoorassic Park | \$5.00 | \$5.00 | \$4.00 | \$3.00 | \$4.00 | \$4.00 | \$4.00 | \$3.00 |

Note: Additional prices/discounts offered for seniors, groups, total experience ticketholders, etc. Free attendance includes babies, complimentary ticketholders, etc. Members can purchase Zoorassic Park season passes.

Per Capita Spending on Grounds (2 of 3)

| | August 2022 | July 2022 | June 2022 | August 2021 |
|-------------------------|---------------|---------------|---------------|---------------|
| Attendance | 45,295 | 55,901 | 65,848 | 44,103 |
| General Admission | 25,894 | 29,672 | 33,613 | 27,044 |
| Total Experience GA | 11,507 | 12,559 | 13,581 | 7,482 |
| Members | 17,489 | 19,648 | 21,797 | 16,342 |
| Programs & Events (P&E) | 1,912 | 6,581 | 10,438 | 717 |
| Giraffe Feeding | | | | |
| Attendance | 18,179 | 18,179 | 19,609 | 13,594 |
| Total Experience | 11,507 | 12,559 | 13,581 | 7,482 |
| Revenue | \$50,059 | \$62,605 | \$74,761 | \$65,982 |
| Capture Rate | 40% | 33% | 30% | 31% |
| Capture Rate, ex. P&E | 33% | 29% | 28% | 27% |
| Average Revenue | \$2.75 | \$3.44 | \$3.81 | \$4.85 |
| Stingray Bay | | | | |
| Attendance | 18,758 | 18,758 | 22,121 | 13,034 |
| Total Experience | 11,507 | 12,559 | 13,581 | 7,482 |
| Revenue | \$23,956 | \$37,456 | \$43,454 | \$34,280 |
| Capture Rate | 41% | 34% | 34% | 30% |
| Capture Rate, ex. P&E | 43% | 38% | 40% | 30% |
| Average Revenue | \$1.28 | \$2.00 | \$1.96 | \$2.63 |
| Zoorassic Park | | | | |
| Attendance | 19,900 | 19,900 | 22,022 | 20700 |
| Total Experience | 11,507 | 12,559 | 13,581 | 7,482 |
| Revenue | \$55,976 | \$88,237 | \$102,198 | \$96,062 |
| Capture Rate | 44% | 36% | 33% | 47% |
| Capture Rate, ex. P&E | 46% | 40% | 40% | 48% |
| Average Revenue | \$2.81 | \$4.43 | \$4.64 | \$4.64 |

Per Capita Spending on Grounds (3 of 3)

| | August 2022 | July 2022 | June 2022 | August 2021 |
|-----------------------------|-------------|-----------|-----------|-------------|
| General Admission | 25,894 | 29,672 | 33,613 | 27,044 |
| Total Experience GA | 11,507 | 12,559 | 13,581 | 7,482 |
| | 44% | 42% | 40% | 28% |
| Members | 17,489 | 19,648 | 21,797 | 16,342 |
| Attendance ex P&E | 43,383 | 49,320 | 55,410 | 43,386 |
| Giraffe | 18,179 | 18,179 | 19,609 | 13,594 |
| Stingray | 18,758 | 18,758 | 22,121 | 13,034 |
| Zoorassic | 19,900 | 19,900 | 22,022 | 20,700 |
| P&E attendance | 1,912 | 6,581 | 10,438 | 717 |
| Total attendance | 45,295 | 55,901 | 65,848 | 44,103 |
| Admissions | \$193,749 | \$281,759 | \$358,014 | \$311,099 |
| Food | \$44,014 | \$60,468 | \$86,481 | \$64,120 |
| Gift Shop | \$23,549 | \$41,929 | \$46,307 | \$34,205 |
| Giraffe | \$50,059 | \$62,605 | \$74,761 | \$65,982 |
| Stingray | \$23,956 | \$37,456 | \$43,454 | \$34,280 |
| Zoorassic | \$55,976 | \$88,237 | \$102,198 | \$96,062 |
| Revenue sub-total | \$391,303 | \$572,454 | \$711,216 | \$605,748 |
| Admissions | \$4.47 | \$5.71 | \$6.46 | \$7.17 |
| Food | \$1.01 | \$1.23 | \$1.56 | \$1.48 |
| Gift | \$0.54 | \$0.85 | \$0.84 | \$0.79 |
| Giraffe | \$1.15 | \$1.27 | \$1.35 | \$1.52 |
| Stingray | \$0.55 | \$0.76 | \$0.78 | \$0.79 |
| Zoorassic | \$1.29 | \$1.79 | \$1.84 | \$2.21 |
| Per capita (GA & members) | \$9.02 | \$11.61 | \$12.84 | \$13.96 |
| Admissions | \$4.28 | \$5.04 | \$5.44 | \$7.05 |
| Food | \$0.97 | \$1.08 | \$1.31 | \$1.45 |
| Gift | \$0.52 | \$0.75 | \$0.70 | \$0.78 |
| Giraffe | \$1.11 | \$1.12 | \$1.14 | \$1.50 |
| Stingray | \$0.53 | \$0.67 | \$0.66 | \$0.78 |
| Zoorassic | \$1.24 | \$1.58 | \$1.55 | \$2.18 |
| Per capita (all attendance) | \$8.64 | \$10.24 | \$10.80 | \$13.73 |

FCZC Balance Sheet – August 2022

| | August 2022 | August 2021 |
|---|----------------------|----------------------|
| ASSETS | | |
| Current Assets | | |
| Cash | \$3,067,678 | \$6,452,567 |
| Short Term Investments-Retention | \$2,565,720 | \$1,553,002 |
| Accounts Receivable | \$6,046,992 | \$6,262,648 |
| Prepaid Expenses | \$152,103 | \$88,759 |
| Total Current Assets | \$11,832,493 | \$14,356,977 |
| Other Assets | | |
| Long Term Investments | \$17,115,978 | \$15,273,479 |
| Buildings, Equipment, Vehicles, and Furniture (net) | \$4,009,512 | \$3,803,521 |
| Exhibits | \$56,229,894 | \$56,769,211 |
| Construction in Progress | \$49,468,678 | \$32,573,292 |
| Goodwill | \$74,026 | \$84,601 |
| Total Other Assets | \$126,898,088 | \$108,504,105 |
| TOTAL ASSETS | \$138,730,581 | \$122,861,082 |
| LIABILITIES AND NET ASSETS | | |
| Liabilities | | |
| Accounts Payable and Accrued Liabilities | \$3,101,872 | \$5,749,755 |
| Deferred Revenue | \$1,263,858 | \$1,216,062 |
| Loan Account PPP | \$0 | \$1,853,770 |
| Retention Payable | \$2,601,676 | \$1,774,688 |
| Long-Term Liabilities | \$91,376 | \$243,779 |
| Total Liabilities | \$7,058,782 | \$10,838,054 |
| Net Assets | | |
| Fund Balance-Without donor restriction | \$120,823,228 | \$110,970,632 |
| Fund Balance-With donor restriction | \$966,039 | \$961,610 |
| Fund Balance-Permanently Restricted | \$75,844 | \$90,785 |
| Fund Balance-Board Designated | \$9,806,688 | \$0 |
| Total Net Assets | \$131,671,799 | \$112,023,028 |
| TOTAL LIABILITIES AND NET ASSETS | \$138,730,581 | \$122,861,082 |

FCZC Balance Sheet – September 2022

| | September 2022 | September 2021 |
|---|----------------------|----------------------|
| ASSETS | | |
| Current Assets | | |
| Cash | \$2,843,739 | \$3,652,461 |
| Short Term Investments-Retention | \$2,627,007 | \$1,688,488 |
| Accounts Receivable | \$4,592,137 | \$6,665,402 |
| Prepaid Expenses | \$152,103 | \$123,866 |
| Total Current Assets | \$10,214,988 | \$12,130,217 |
| Other Assets | | |
| Long Term Investments | \$17,115,978 | \$17,843,071 |
| Buildings, Equipment, Vehicles, and Furniture (net) | \$4,038,848 | \$3,770,497 |
| Exhibits | \$56,229,894 | \$56,428,883 |
| Construction in Progress | \$49,477,788 | \$35,284,987 |
| Goodwill | \$74,026 | \$83,640 |
| Total Other Assets | \$126,936,534 | \$113,411,078 |
| TOTAL ASSETS | \$137,151,521 | \$125,541,296 |
| LIABILITIES AND NET ASSETS | | |
| Liabilities | | |
| Accounts Payable and Accrued Liabilities | \$2,184,580 | \$6,141,369 |
| Deferred Revenue | \$1,304,004 | \$1,227,893 |
| Loan Account PPP | \$0 | \$1,853,770 |
| Retention Payable | \$2,601,676 | \$1,938,746 |
| Long-Term Liabilities | \$91,376 | \$243,779 |
| Total Liabilities | \$6,181,636 | \$11,405,558 |
| Net Assets | | |
| Fund Balance-Without donor restriction | \$120,115,017 | \$113,070,509 |
| Fund Balance-With donor restriction | \$971,337 | \$977,476 |
| Fund Balance-Permanently Restricted | \$75,844 | \$87,753 |
| Fund Balance-Board Designated | \$9,807,688 | \$0 |
| Total Net Assets | \$130,969,885 | \$114,135,738 |
| TOTAL LIABILITIES AND NET ASSETS | \$137,151,521 | \$125,541,296 |

DRAFT – subject to
final month-end
adjustments



AGENDA ITEM 9

DATE: October 26, 2022

TO: Fresno County Zoo Authority Board

FROM: Jon Forrest Dohlin, Chief Executive Officer
Fresno's Chaffee Zoo Corporation

SUBJECT: Completed Projects Remaining Funds

RECOMMENDED ACTION:

Receive and approve request from Fresno's Chaffee Zoo Corporation to release remaining Measure Z budgeted funds from the Mixed Species Demolition in the total amount of \$1,727.50.



AGENDA ITEM 10

DATE: October 26, 2022

TO: Fresno County Zoo Authority Board

FROM: Jon Forrest Dohlin, Chief Executive Officer
Fresno's Chaffee Zoo Corporation

SUBJECT: African River Design Remaining Funds

RECOMMENDED ACTION:

Receive and approve request from Fresno Chaffee Zoo Corporation to release remaining Measure Z budgeted funds from the African River Design in the amount of \$2,830,342.30.

DISCUSSION:

In February 2021, the design progress on African River was temporarily halted to allow for the ZooCorp to go through its Purpose Plan process, which included a reevaluation of the Master Plan. Upon completion of the Master Plan, and with approval from its Board of Directors on September 8, 2022, ZooCorp has moved to further suspend design work on the African River Exhibit. Below are the key reasons for this decision:

1. The addition of African River to the greater African Adventure exhibit space enhances an already excellent exhibit experience. Allocation of financial resources to this area would impede ZooCorp's ability to address aged infrastructure and outdated exhibit spaces in the immediate future.
2. This project ignores immediate needs of the Zoo that were identified through the Purpose Plan process:
 - a. Better entry flow for guests
 - b. Enhanced circulation paths throughout the Zoo
 - c. Replacement of older exhibit spaces that are no longer in compliance with current animal care, wellbeing and husbandry standards as set forth by the AZA
3. First proposed exhibit on the Master Plan is a new Entry & California-centric exhibit highlighting the diverse flora and fauna of our home state. The Entry would address many of the bottleneck issues currently experienced by guests today. The California exhibit would be a unique mission-centric collection of species habitats amongst AZA institutions, and one that celebrates the history and ecosystems of our State and Valley. Allocation of financial resources to African River would prohibit us from moving forward with this combined project in a meaningful way for several years.

Upon suspension of this design work, ZooCorp would retain rights and ownership of all progress made on the exhibit design to date allowing work to resume on the project at such a time deemed appropriate by ZooCorp management and its Board of Directors.



AGENDA ITEM 11

DATE: October 26, 2022

TO: Fresno County Zoo Authority Board

FROM: Jon Forrest Dohlin, Chief Executive Officer
Fresno Chaffee Zoo Corporation

SUBJECT: Request Retention Release for Studio Hanson Roberts for African River

RECOMMENDED ACTION:

Approve and authorize release of retention withheld on design work provided by Studio Hanson Roberts related to African Rivers Exhibit (\$11,956.50).

DISCUSSION:

In accordance with the Retention Policy Adopted September 30, 2015, and Revised January 30, 2019, retention of 5% was withheld on the Developed Design work phase provided by Studio Hanson Roberts as related to the African Rivers Exhibit capital project. The total contract for this phase was \$797,100, of which \$239,130 has been completed to date. Total retention related to this phase is \$11,956.50.

ZooCorp, with the approval of its Board of Directors, has decided to suspend progress on the African Rivers Exhibit until further notice. As such, ZooCorp believes it prudent to remit the withheld retention of \$11,965.50. Therefore, we are requesting release of the stated retention.

Fresno's Chaffee Zoo Corporation Board of Directors approved this request at a previous meeting.

ATTACHMENTS:

Studio Hanson Roberts Invoice



Planning & Design for Wild **Life**

28 February 2021

Scott Barton, Chief Executive Officer
Jesse Santiago, Project Manager
Fresno Chaffee Zoo
894 West Belmont Avenue
Fresno, California 93728

Fresno Chaffee Zoo – African Rivers Exhibit
Invoice Number 12 - 210228

Invoice Period: 1 December 2020 – 28 February 2021

Professional Services Fees:

| Service Description: | Fee Subtotal | % Complete | Fee Earned |
|---|------------------------|------------|-----------------|
| Concept Design | USD 100,400.00 | 100%..... | USD 100,400.00 |
| Schematic Design (20% per month) | USD 480,250.00 | 100%..... | USD 480,250.00 |
| Developed Design (15% per month)..... | USD 797,100.00 | 30%..... | USD 239,130.00 |
| Construction Documents..... | USD 1,089,000.00 | 0%..... | USD 0.00 |
| Bidding..... | USD 76,700.00 | 0%..... | USD 0.00 |
| Construction Administration | USD 690,400.00 | 0%..... | USD 0.00 |
| Total Fee: USD 3,233,850.00 | | | |
| Total Professional Services completed to Date | | | USD 819,780.00 |
| Amount Previously Invoiced: (USD | | | 819,780.00) |
| Subtotal Professional Services Fees Due this Invoice: | | | USD 0.00 |

Retention Release:

| | | | |
|--------------------------------------|----------------------|---------|----------------------|
| 30% Schematic Design Retention | USD 239,130.00 | 5%..... | USD 11,956.50 |
| Retention Release Due this Invoice: | | | USD 11,956.50 |
| Total Amount Due this Invoice: | | | USD 11,956.50 |

Instructions for Wiring Funds to *Studio Hanson|Roberts*:

Studio Hanson/Roberts, c/o Bank of America, 1200 Hildebrand Lane, Bainbridge Island Washington, 98110 USA
VP|Client Manager: Blayre Stephenson , telephone: 001.1 800 852-5000 ex 8229
Email: Blayre.Stephenson@baml.com
Bank of America Routing #: 125000024; Account #: 60147105; Wire Transfer: ABA 026 009 593; Swift Code: BOFAUS3N

250 Madrona Way N. E. #220
Bainbridge Island, WA 98110, USA
tel | + 1.206.842.8332
fax | + 1.206.842.8326

www.studio-hansonroberts.com